



Meridian Solar Farm

EN010169

Volume 2

Plans

2.12 Hedgerow
Regulations and Tree
Preservation Orders Plan –
Section A Solar
Development Area

APFP Regulation 5(2)(1)

Infrastructure Planning (Applications:
Prescribed Forms and Procedure)
Regulations 2009

March 2026

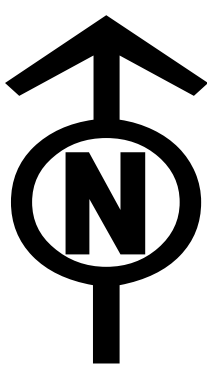

MERIDIAN SOLAR FARM
 HEDGEROW REGULATIONS AND TREE PRESERVATION ORDER KEY PLAN
 REGULATION 5(2)(o)
 SECTION A SHEET 1 OF 1

SITE MAP

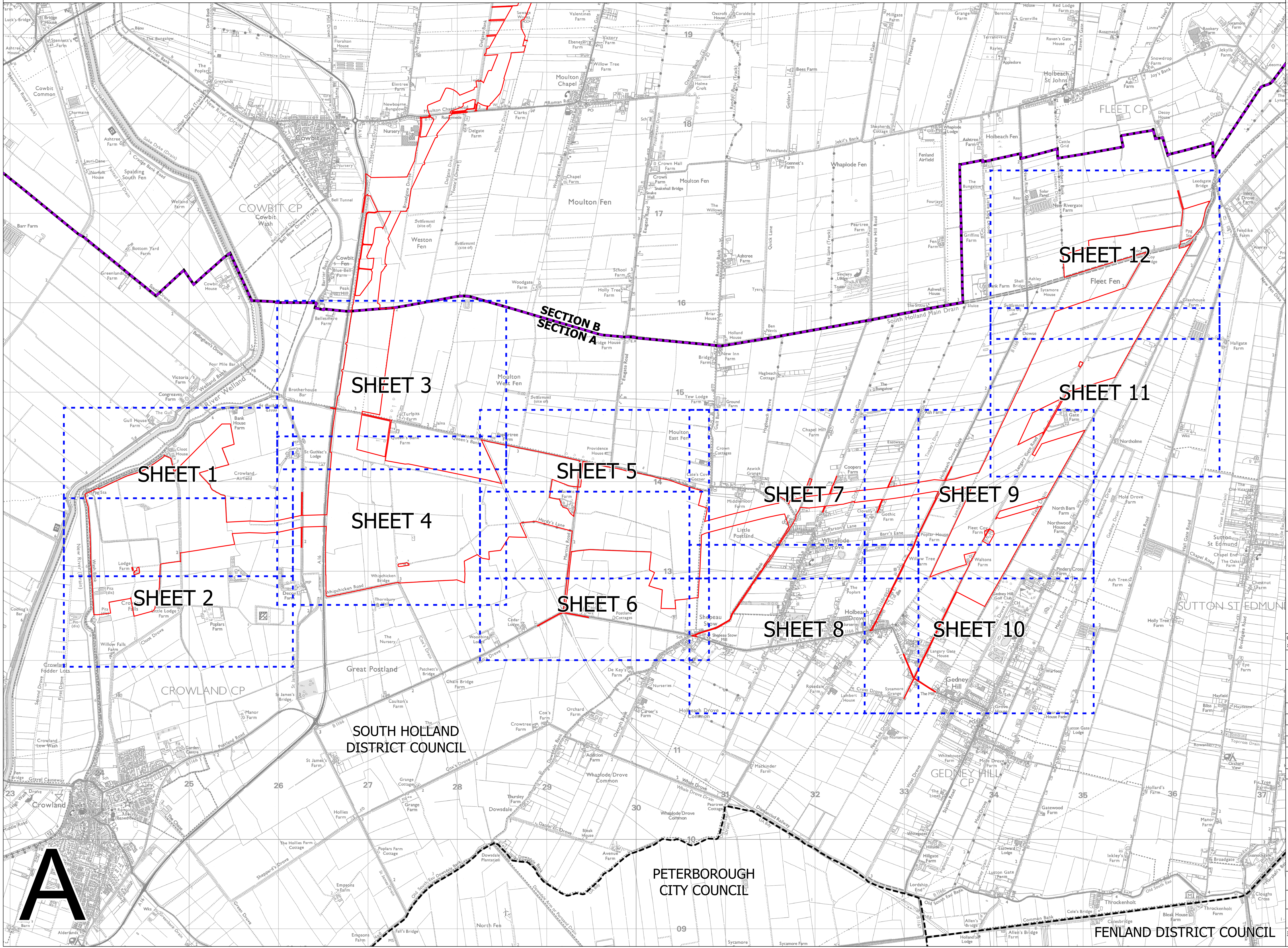
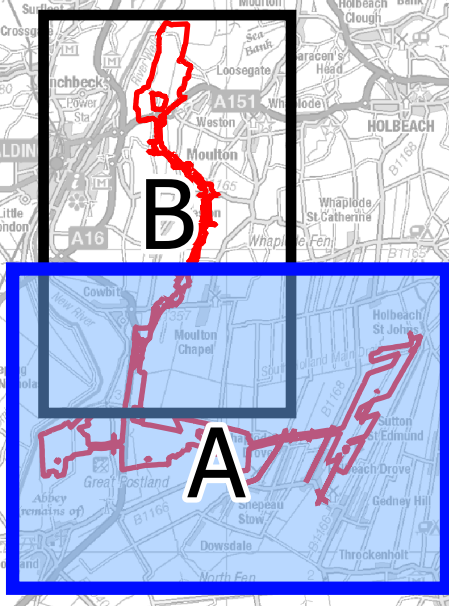

- LEGEND**
- Local authority boundary
 - Section boundary
 - Sheet index
 - Order Limits

Notes

This drawing is scaled at paper size A0, therefore any prints taken at smaller sizes will affect accuracy of the measurement units and should not be scaled against.

The local authorities' boundaries and titles are correct at the time of submission.

Coordinate System: British National Grid
 Sheet X Centroid Coordinate: 530092 Sheet Y Centroid Coordinate: 314080

BACKGROUND MAPPING INFORMATION HAS BEEN REPRODUCED FROM THE ORDNANCE SURVEY BY PERMISSION OF ORDNANCE SURVEY OF THE CONTROLLER OF HIS MAJESTY'S STATIONERY OFFICE © CROWN COPYRIGHT AND DATABASE RIGHTS (2025) ORDNANCE SURVEY AC000080122. BLUESKY INTERNATIONAL LTD ©

Issue	Date	Remarks	Drawn	Checked	Approved
0	MAR 2026	FOR DCO SUBMISSION	AT	JB	NT

Title

MERIDIAN SOLAR FARM
 HEDGEROW REGULATIONS AND
 TREE PRESERVATION ORDER
 KEY PLAN
 REGULATION 5(2)(o)
 SECTION A SHEET 1 OF 1

Application Number
 EN010169

Meridian Drawing Reference
 DCO_AVR/KP/01

Scale	Sheet Size	Sheet	Issue
1:14,000	A0	SHEET 1 OF 1	0

A

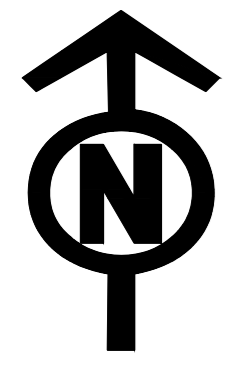

MERIDIAN SOLAR FARM
 HEDGEROW REGULATIONS AND TREE PRESERVATION ORDER PLAN
 REGULATION 5(2)(o)
 SECTION A SHEET 1 OF 12

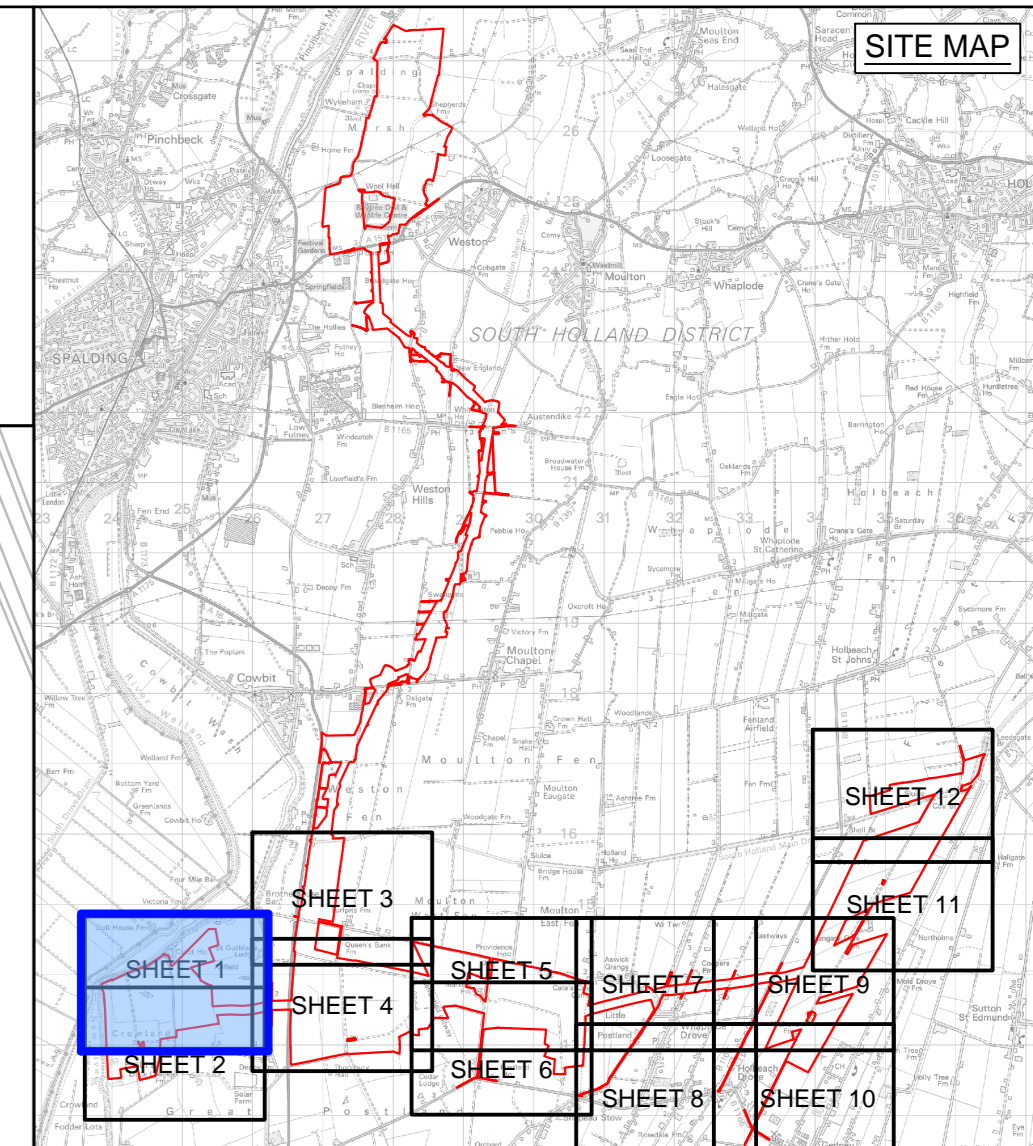

A

LEGEND

- Sheet index cutlines
- Order Limits
- Existing Preliminary Ecological Appraisal hedgerow
 - Removed
 - Retained
- Surveyed and National Tree Map trees within existing hedgerow
 - Removed
 - Retained

Notes

This drawing is scaled at paper size A0, therefore any prints taken at smaller sizes will affect accuracy of the measurement units and should not be scaled against.

The local authorities' boundaries and titles are correct at the time of submission.

No historically important hedgerows have been identified within the order limits.

For information on the types of works (i.e. removed / affected managed / potentially impacted) and the removal of trees, refer to the ES Appendix 12-8: Arboricultural Impact Assessment (Doc Ref. 6.3).

Copyright:
 National Tree Map - © Bluesky International Limited, National Hedgerow Map - © Bluesky International Limited, reproduced from Ordnance Survey digital map data © Crown Copyright 2025. All rights reserved. Licence number AC00008122. Contains public sector information licensed under the Open Government Licence v3.0.

Tree categories as defined by BS 5837:2012.

Tree locations are based on aerial imagery and GPS co-ordinates from on site walkover.

*Indicates a tree / group whose position is approximate as based upon aerial photography and on site observations.

The original of this drawing was produced in colour - a monochrome copy should not be relied upon.

Hedgerow loss is shown indicatively; the final location of hedgerow removals may change, however the extent of removal will be consistent with that shown. Where the position of hedgerow loss is subject to change, it will avoid the removal of moderate or high quality tree features.

Coordinate System: British National Grid
 Sheet X Centroid Coordinate: 524879 Sheet Y Centroid Coordinate: 313886



BACKGROUND MAPPING INFORMATION HAS BEEN REPRODUCED FROM THE ORDNANCE SURVEY BY PERMISSION OF ORDNANCE SURVEY OF THE CONTROLLER OF HIS MAJESTY'S STATIONERY OFFICE. © CROWN COPYRIGHT AND DATABASE RIGHTS (2025) ORDNANCE SURVEY AC00008122

Issue	Date	Remarks	Drawn	Checked	Approved
0	MAR 2026	FOR DCO SUBMISSION	LH	TR	AW

Title

MERIDIAN SOLAR FARM
 HEDGEROW REGULATIONS AND TREE PRESERVATION ORDER PLAN
 REGULATION 5(2)(o)
 SECTION A SHEET 1 OF 12



Application Number
 EN010169

Meridian Drawing Reference
 DCO_A/VR/PS/1

Scale	Sheet Size	Sheet	Issue
1:2500	A0	SHEET 1 OF 12	0

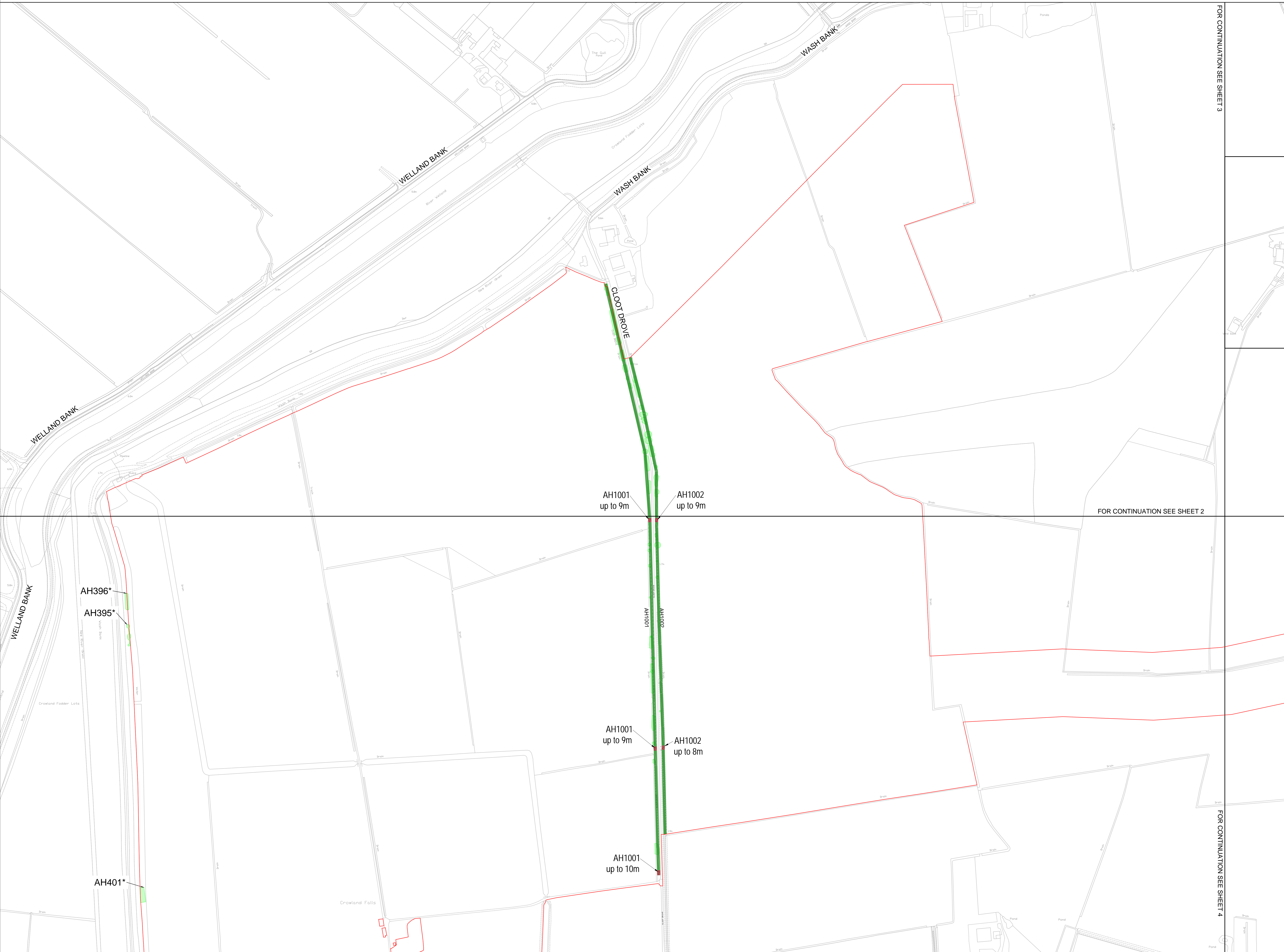

FOR CONTINUATION SEE SHEET 3

FOR CONTINUATION SEE SHEET 2

FOR CONTINUATION SEE SHEET 4



MERIDIAN SOLAR FARM
 HEDGEROW REGULATIONS AND TREE PRESERVATION ORDER PLAN
 REGULATION 5(2)(o)
 SECTION A SHEET 2 OF 12

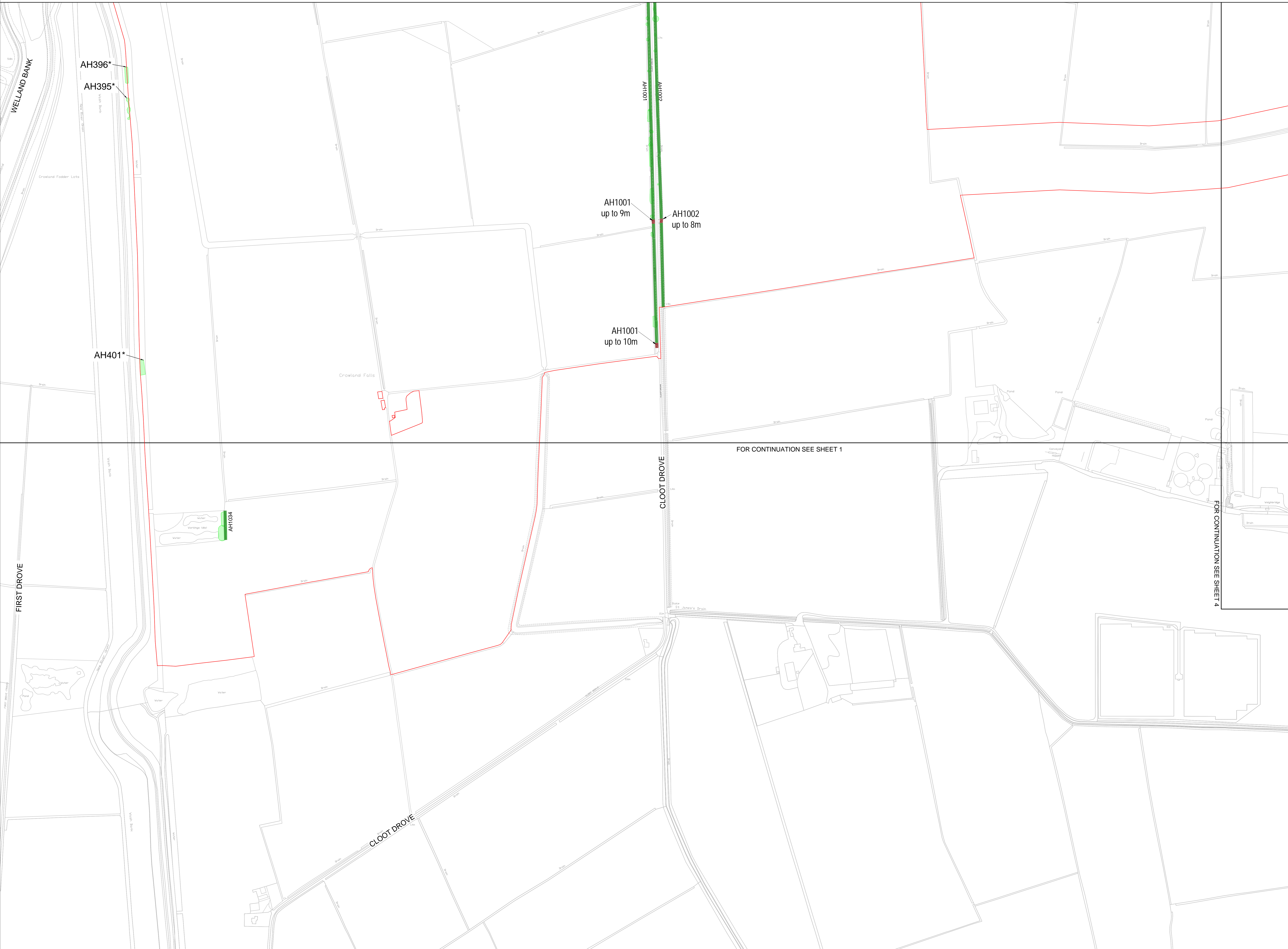
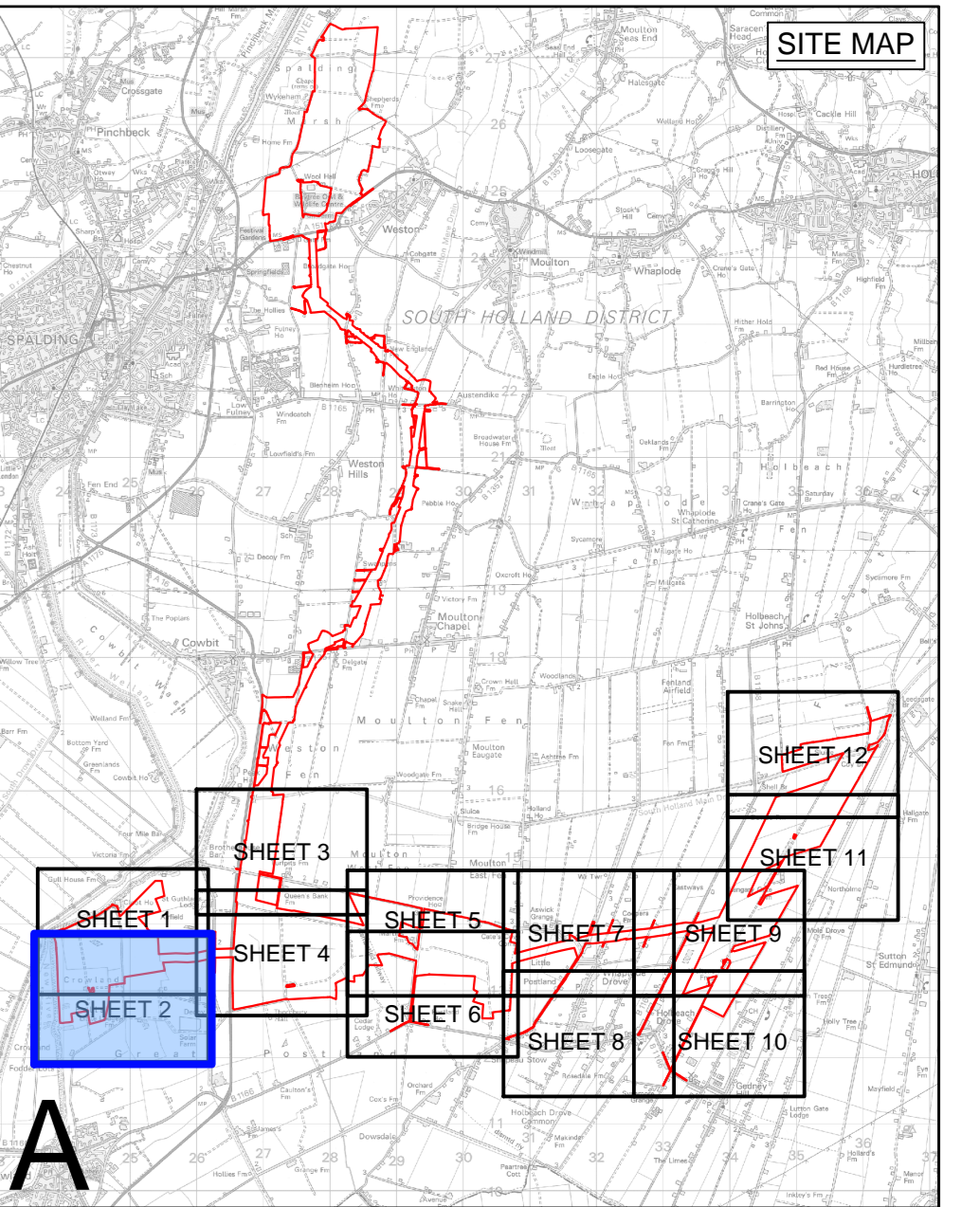

LEGEND

- Sheet index outlines
- Order Limits
- Tree Preservation Order
- Existing Preliminary Ecological Appraisal hedgerow
- Removed
- Retained
- Surveyed and National Tree Map trees within existing hedgerow
- Removed
- Retained

Notes

This drawing is scaled at paper size A0, therefore any prints taken at smaller sizes will affect accuracy of the measurement units and should not be scaled against.

The local authorities' boundaries and titles are correct at the time of submission.

No historically important hedgerows have been identified within the order limits.

For information on the types of works (i.e. removed / affected managed / potentially impacted) and the removal of trees, refer to the ES Appendix 12-8: Arboricultural Impact Assessment (Doc Ref. 6.3).

Copyright:
 National Tree Map - © Bluesky International Limited, National Hedgerow Map - © Bluesky International Limited, reproduced from Ordnance Survey digital map data © Crown Copyright 2025. All rights reserved. Licence number AC00008122. Contains public sector information licensed under the Open Government Licence v3.0.

Tree categories as defined by BS 5837:2012.

Tree locations are based on aerial imagery and GPS co-ordinates from on site walkover.

*Indicates a tree / group whose position is approximate as based upon aerial photography and on site observations.

The original of this drawing was produced in colour - a monochrome copy should not be relied upon.

Hedgerow loss is shown indicatively; the final location of hedgerow removals may change, however the extent of removal will be consistent with that shown. Where the position of hedgerow loss is subject to change, it will avoid the removal of moderate or high quality tree features.

Coordinate System: British National Grid
 Sheet X Centroid Coordinate: 524879 Sheet Y Centroid Coordinate: 312873

BACKGROUND MAPPING INFORMATION HAS BEEN REPRODUCED FROM THE ORDNANCE SURVEY BY PERMISSION OF ORDNANCE SURVEY OF THE CONTROLLER OF HIS MAJESTY'S STATIONERY OFFICE. © CROWN COPYRIGHT AND DATABASE RIGHTS (2025) ORDNANCE SURVEY AC00008122

Issue	Date	Remarks	Drawn	Checked	Approved
0	MAR 2026	FOR DCO SUBMISSION	LH	TR	AW

Title

MERIDIAN SOLAR FARM
 HEDGEROW REGULATIONS AND TREE PRESERVATION ORDER PLAN
 REGULATION 5(2)(o)
 SECTION A SHEET 2 OF 12

Application Number	EN010169
Meridian Drawing Reference	DCO_A/VR/PS/2
Scale	1:2500
Sheet Size	A0
Sheet	SHEET 2 OF 12
Issue	0



MERIDIAN SOLAR FARM
 HEDGEROW REGULATIONS AND TREE PRESERVATION ORDER PLAN
 REGULATION 5(2)(o)
 SECTION A SHEET 3 OF 12

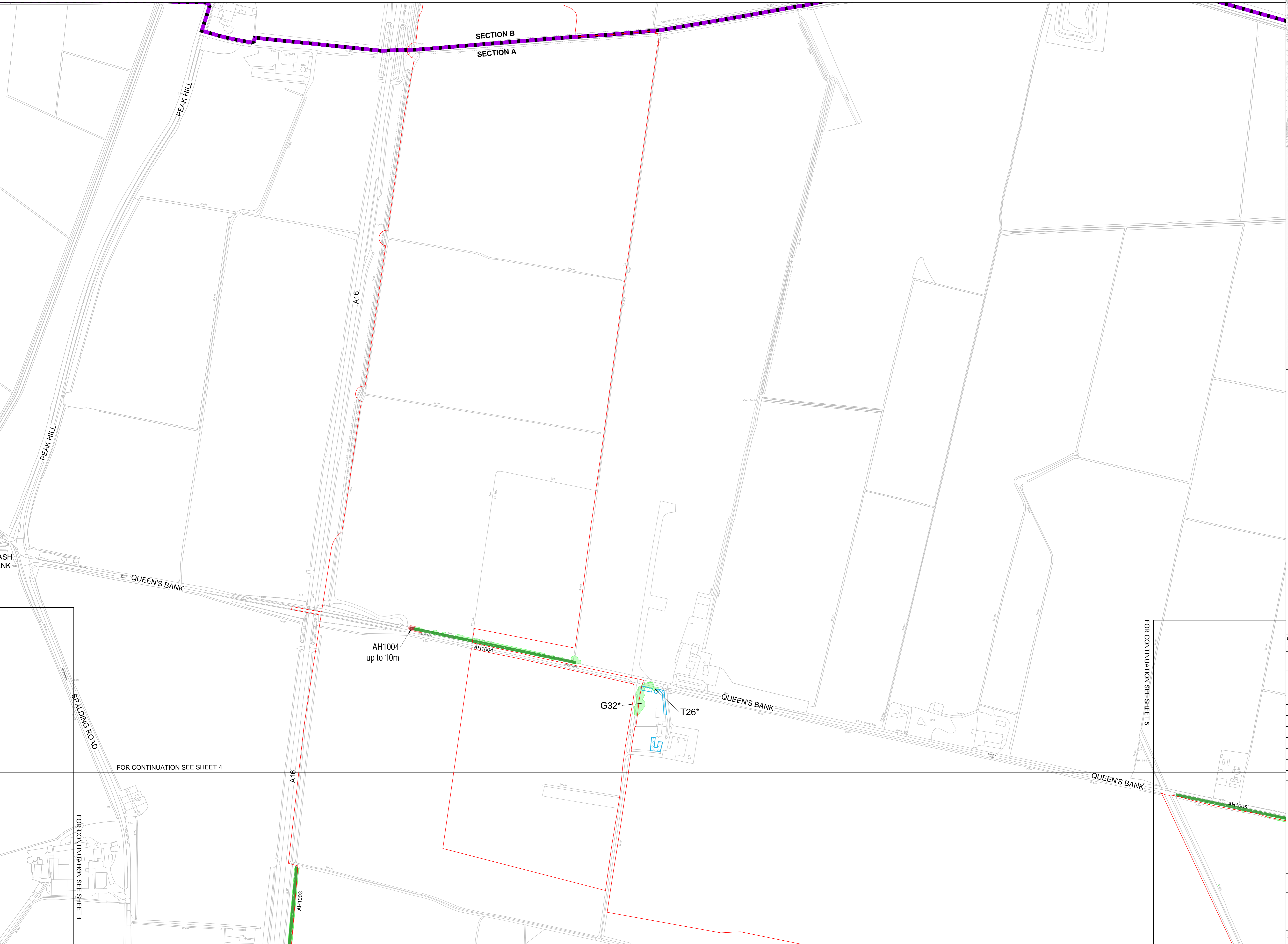
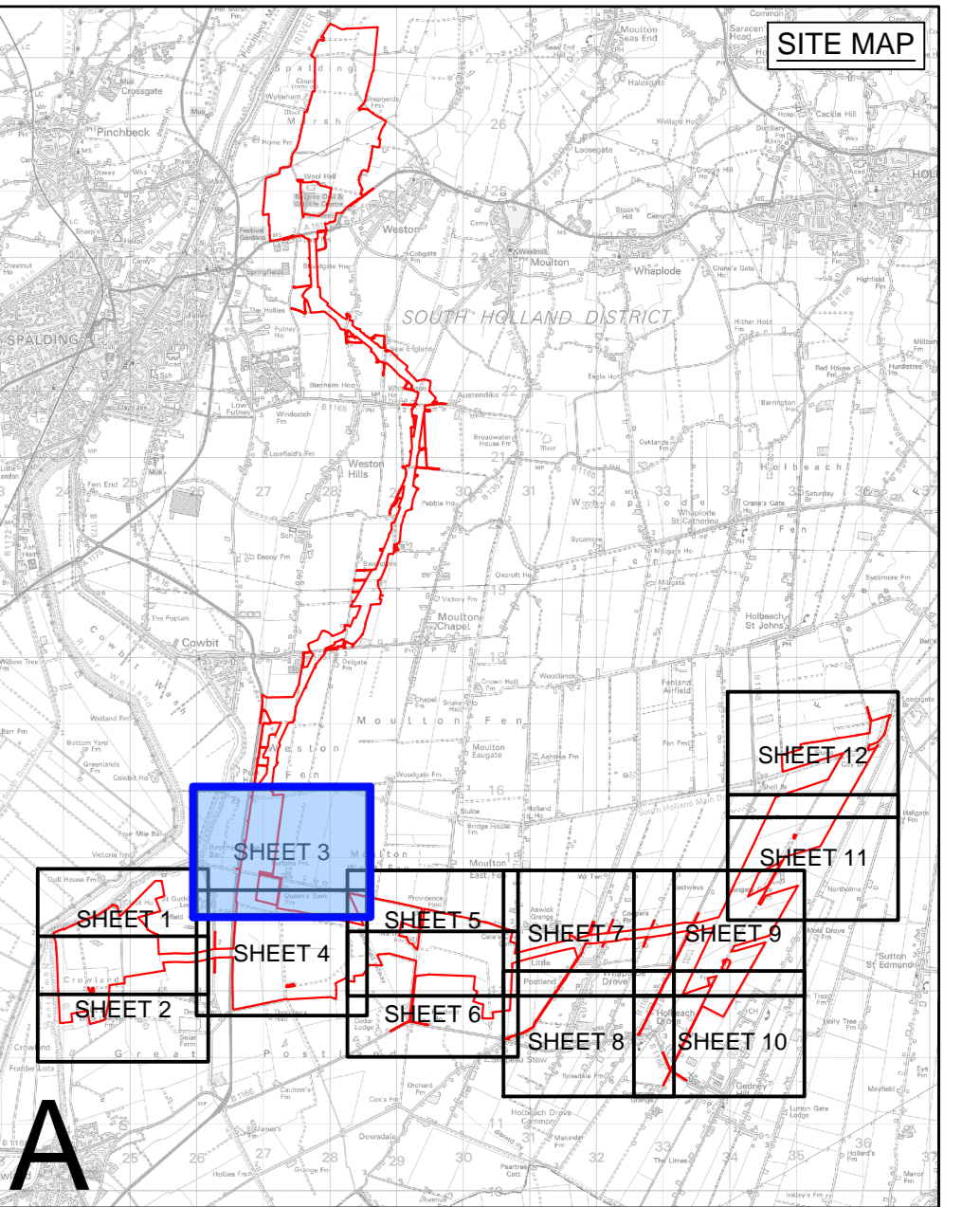

LEGEND

- Section boundary
- Sheet index outlines
- Order Limits
- Tree Preservation Order
- Existing Preliminary Ecological Appraisal hedgerow
- Removed
- Retained
- Surveyed and National Tree Map trees within existing hedgerow
- Removed
- Retained

Notes

This drawing is scaled at paper size A0, therefore any prints taken at smaller sizes will affect accuracy of the measurement units and should not be scaled against.

The local authorities' boundaries and titles are correct at the time of submission.

No historically important hedgerows have been identified within the order limits.

For information on the types of works (i.e. removed / affected managed / potentially impacted) and the removal of trees, refer to the ES Appendix 12-8: Agricultural Impact Assessment (Doc Ref. 6.3).

Copyright:
 National Tree Map – © Bluesky International Limited, National Hedgerow Map – © Bluesky International Limited, reproduced from Ordnance Survey digital map data © Crown Copyright 2025. All rights reserved. Licence number AC00008122. Contains public sector information licensed under the Open Government Licence v3.0.

Tree categories as defined by BS 5837:2012.

Tree locations are based on aerial imagery and GPS co-ordinates from on site walkover.

*Indicates a tree / group whose position is approximate as based upon aerial photography and on site observations.

The original of this drawing was produced in colour – a monochrome copy should not be relied upon.

Hedgerow loss is shown indicatively; the final location of hedgerow removals may change, however the extent of removal will be consistent with that shown. Where the position of hedgerow loss is subject to change, it will avoid the removal of moderate or high quality tree features.

Coordinate System: British National Grid
 Sheet X Centroid Coordinate: 527265 Sheet Y Centroid Coordinate: 315081

BACKGROUND MAPPING INFORMATION HAS BEEN REPRODUCED FROM THE ORDNANCE SURVEY BY PERMISSION OF ORDNANCE SURVEY OF THE CONTROLLER OF HIS MAJESTY'S STATIONERY OFFICE. © CROWN COPYRIGHT AND DATABASE RIGHTS (2025) ORDNANCE SURVEY AC00008122

Issue	Date	Remarks	Drawn	Checked	Approved
0	MAR 2026	FOR DCO SUBMISSION	LH	TR	AW

Title

MERIDIAN SOLAR FARM
 HEDGEROW REGULATIONS AND TREE
 PRESERVATION ORDER PLAN
 REGULATION 5(2)(o)
 SECTION A SHEET 3 OF 12

Application Number: EN010169

Meridian Drawing Reference: DCO_AVR/PS/3

Scale	Sheet Size	Sheet	Issue
1:2500	A0	SHEET 3 OF 12	0



MERIDIAN SOLAR FARM
 HEDGEROW REGULATIONS AND TREE PRESERVATION ORDER PLAN
 REGULATION 5(2)(o)
 SECTION A SHEET 4 OF 12

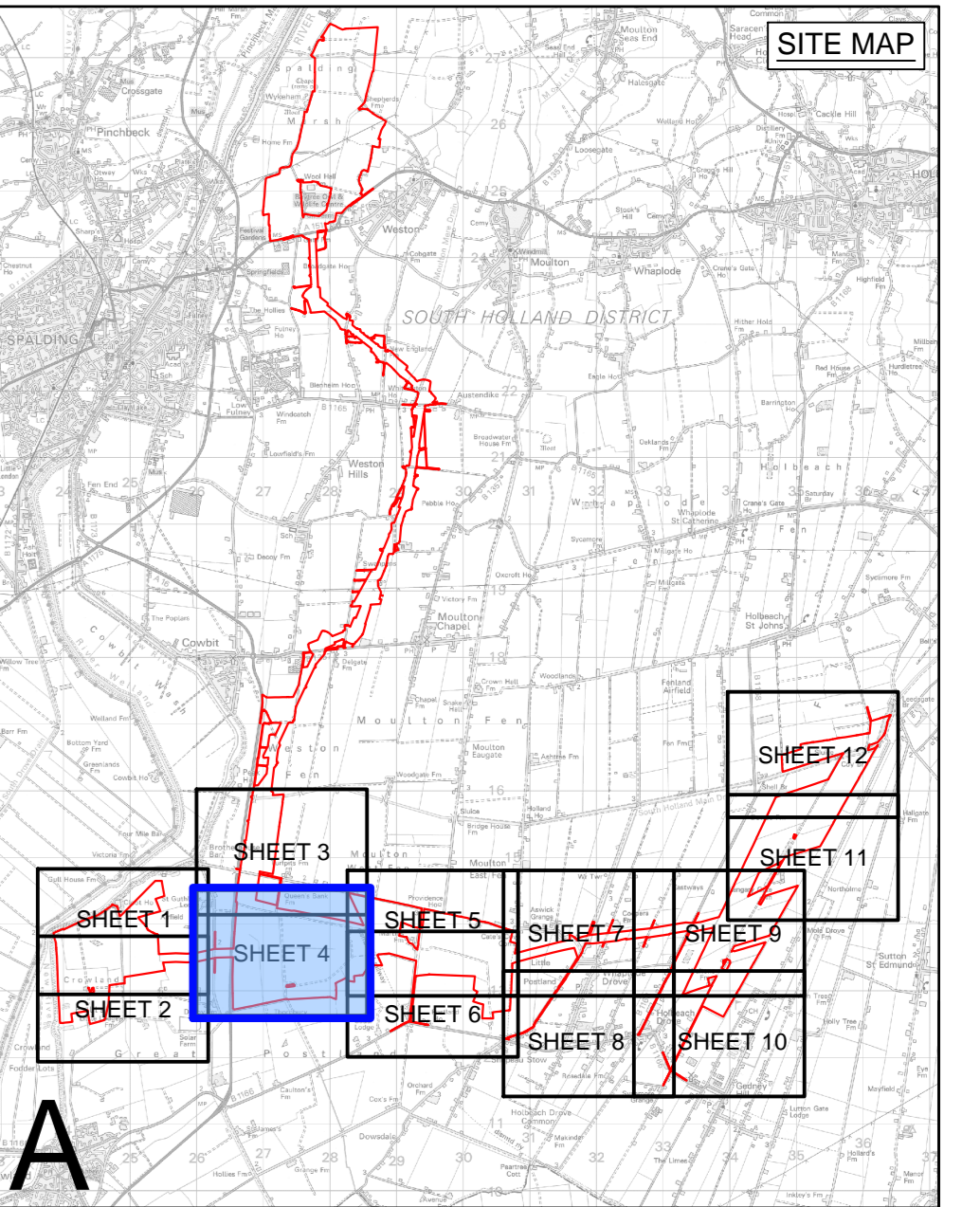

A

LEGEND

- Sheet index cutlines
- Order Limits
- Tree Preservation Order
- Existing Preliminary Ecological Appraisal hedgerow
- Removed
- Retained
- Surveyed and National Tree Map trees within existing hedgerow
- Removed
- Retained

Notes

This drawing is scaled at paper size A0, therefore any prints taken at smaller sizes will affect accuracy of the measurement units and should not be scaled against.

The local authorities' boundaries and titles are correct at the time of submission.

No historically important hedgerows have been identified within the order limits.

For information on the types of works (i.e. removed / affected managed / potentially impacted) and the removal of trees, refer to the ES Appendix 12-8: Arboricultural Impact Assessment (Doc Ref. 6.3).

Copyright:
 National Tree Map – © Bluesky International Limited, National Hedgerow Map – © Bluesky International Limited, reproduced from Ordnance Survey digital map data © Crown Copyright 2025. All rights reserved. Licence number AC000080122. Contains public sector information licensed under the Open Government Licence v3.0.

Tree categories as defined by BS 5837:2012.

Tree locations are based on aerial imagery and GPS co-ordinates from on site walkover.

*Indicates a tree / group whose position is approximate as based upon aerial photography and on site observations.

The original of this drawing was produced in colour – a monochrome copy should not be relied upon.

Hedgerow loss is shown indicatively; the final location of hedgerow removals may change, however the extent of removal will be consistent with that shown. Where the position of hedgerow loss is subject to change, it will avoid the removal of moderate or high quality tree features.

Coordinate System: British National Grid
 Sheet X Centroid Coordinate: 527265 Sheet Y Centroid Coordinate: 313565



BACKGROUND MAPPING INFORMATION HAS BEEN REPRODUCED FROM THE ORDNANCE SURVEY BY PERMISSION OF ORDNANCE SURVEY OF THE CONTROLLER OF HIS MAJESTY'S STATIONERY OFFICE. © CROWN COPYRIGHT AND DATABASE RIGHTS (2025) ORDNANCE SURVEY AC000080122

Issue	Date	Remarks	Drawn	Checked	Approved
0	MAR 2026	FOR DCO SUBMISSION	LH	TR	AW

Title

MERIDIAN SOLAR FARM
 HEDGEROW REGULATIONS AND TREE PRESERVATION ORDER PLAN
 REGULATION 5(2)(o)
 SECTION A SHEET 4 OF 12



Application Number EN010169

Meridian Drawing Reference DCO_AVR/PS/4

Scale	Sheet Size	Sheet	Issue
1:2500	A0	SHEET 4 OF 12	0

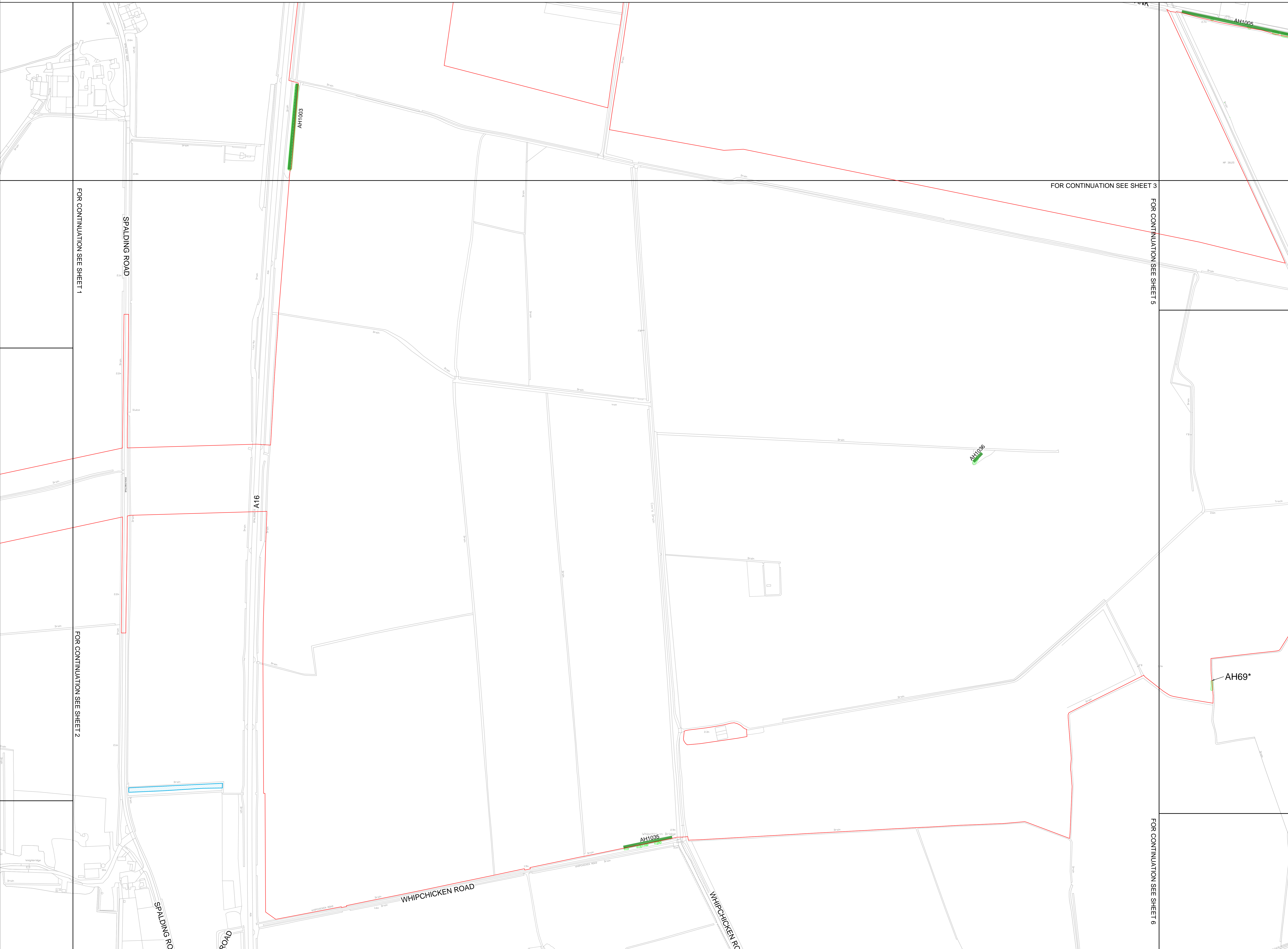



MERIDIAN SOLAR FARM
 HEDGEROW REGULATIONS AND TREE PRESERVATION ORDER PLAN
 REGULATION 5(2)(o)
 SECTION A SHEET 5 OF 12

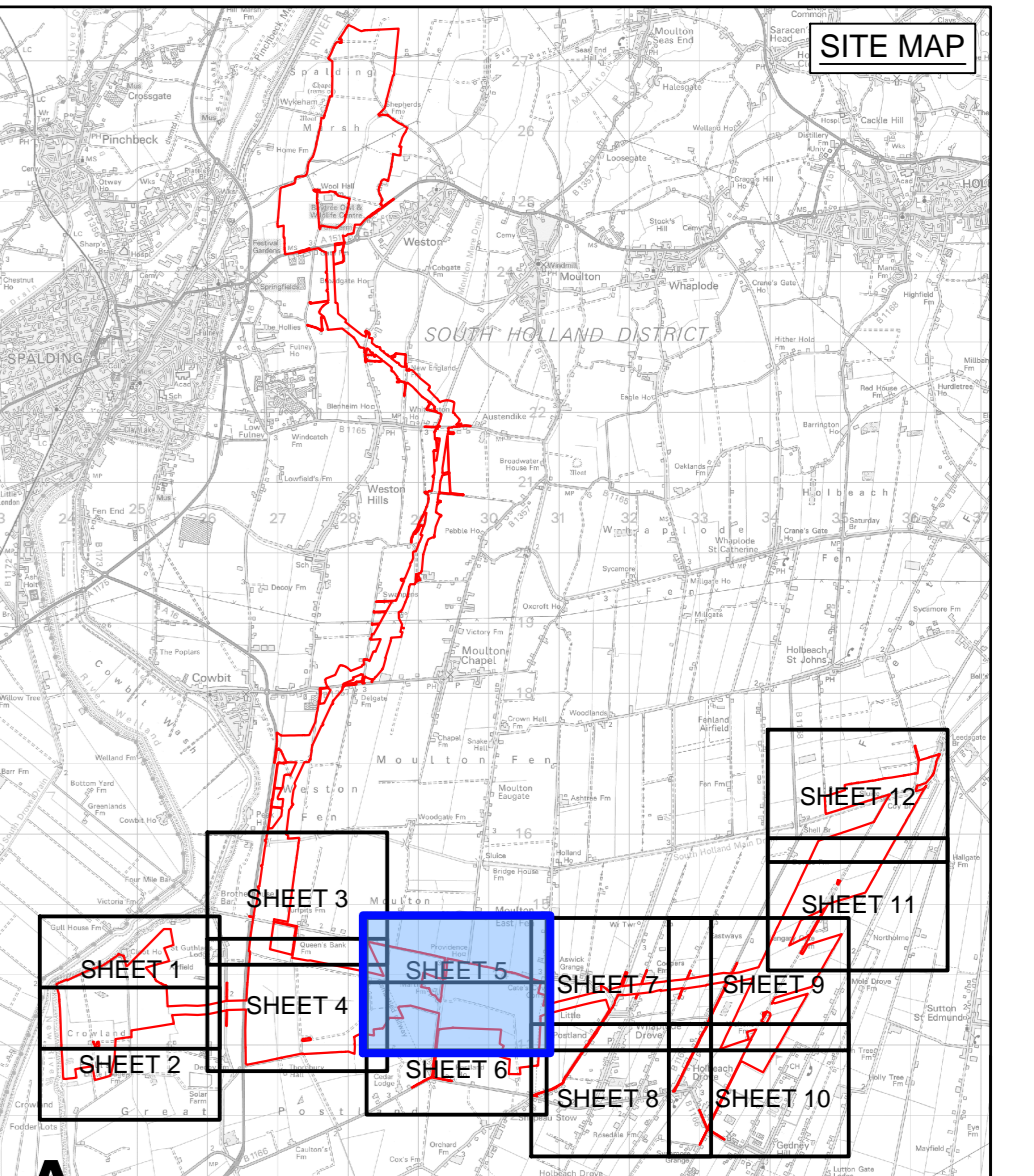

A

LEGEND

- Sheet index outlines
- Order Limits
- Existing Preliminary Ecological Appraisal hedgerow
- Removed
- Retained
- Surveyed and National Tree Map trees within existing hedgerow
- Removed
- Retained

Notes

This drawing is scaled at paper size A0, therefore any prints taken at smaller sizes will affect accuracy of the measurement units and should not be scaled against.

The local authorities' boundaries and titles are correct at the time of submission.

No historically important hedgerows have been identified within the order limits.

For information on the types of works (i.e. removed / affected managed / potentially impacted) and the removal of trees, refer to the ES Appendix 12-8: Artificial Impact Assessment (Doc Ref. 6.3).

Copyright:
 National Tree Map - © Bluesky International Limited, National Hedgerow Map - © Bluesky International Limited, reproduced from Ordnance Survey digital map data © Crown Copyright 2025. All rights reserved. Licence number AC0000808122. Contains public sector information licensed under the Open Government Licence v3.0.

Tree categories as defined by BS 5837:2012.

Tree locations are based on aerial imagery and GPS co-ordinates from on site walkover.

*Indicates a tree / group whose position is approximate as based upon aerial photography and on site observations.

The original of this drawing was produced in colour - a monochrome copy should not be relied upon.

Hedgerow loss is shown indicatively; the final location of hedgerow removals may change, however the extent of removal will be consistent with that shown. Where the position of hedgerow loss is subject to change, it will avoid the removal of moderate or high quality tree features.

Coordinate System: British National Grid
 Sheet X Centroid Coordinate: 529534 Sheet Y Centroid Coordinate: 313861

BACKGROUND MAPPING INFORMATION HAS BEEN REPRODUCED FROM THE ORDNANCE SURVEY BY PERMISSION OF ORDNANCE SURVEY OF THE CONTROLLER OF HIS MAJESTY'S STATIONERY OFFICE. © CROWN COPYRIGHT AND DATABASE RIGHTS (2025) ORDNANCE SURVEY AC0000808122

Issue	Date	Remarks	Drawn	Checked	Approved
0	MAR 2026	FOR DCO SUBMISSION	LH	TR	AW

Title

**MERIDIAN SOLAR FARM
 HEDGEROW REGULATIONS AND TREE
 PRESERVATION ORDER PLAN
 REGULATION 5(2)(o)
 SECTION A SHEET 5 OF 12**

Application Number			
EN010169			
Meridian Drawing Reference			
DCO_A/VR/PS/5			
Scale	Sheet Size	Sheet	Issue
1:2500	A0	SHEET 5 OF 12	0





MERIDIAN SOLAR FARM
 HEDGEROW REGULATIONS AND TREE PRESERVATION ORDER PLAN
 REGULATION 5(2)(o)
 SECTION A SHEET 6 OF 12

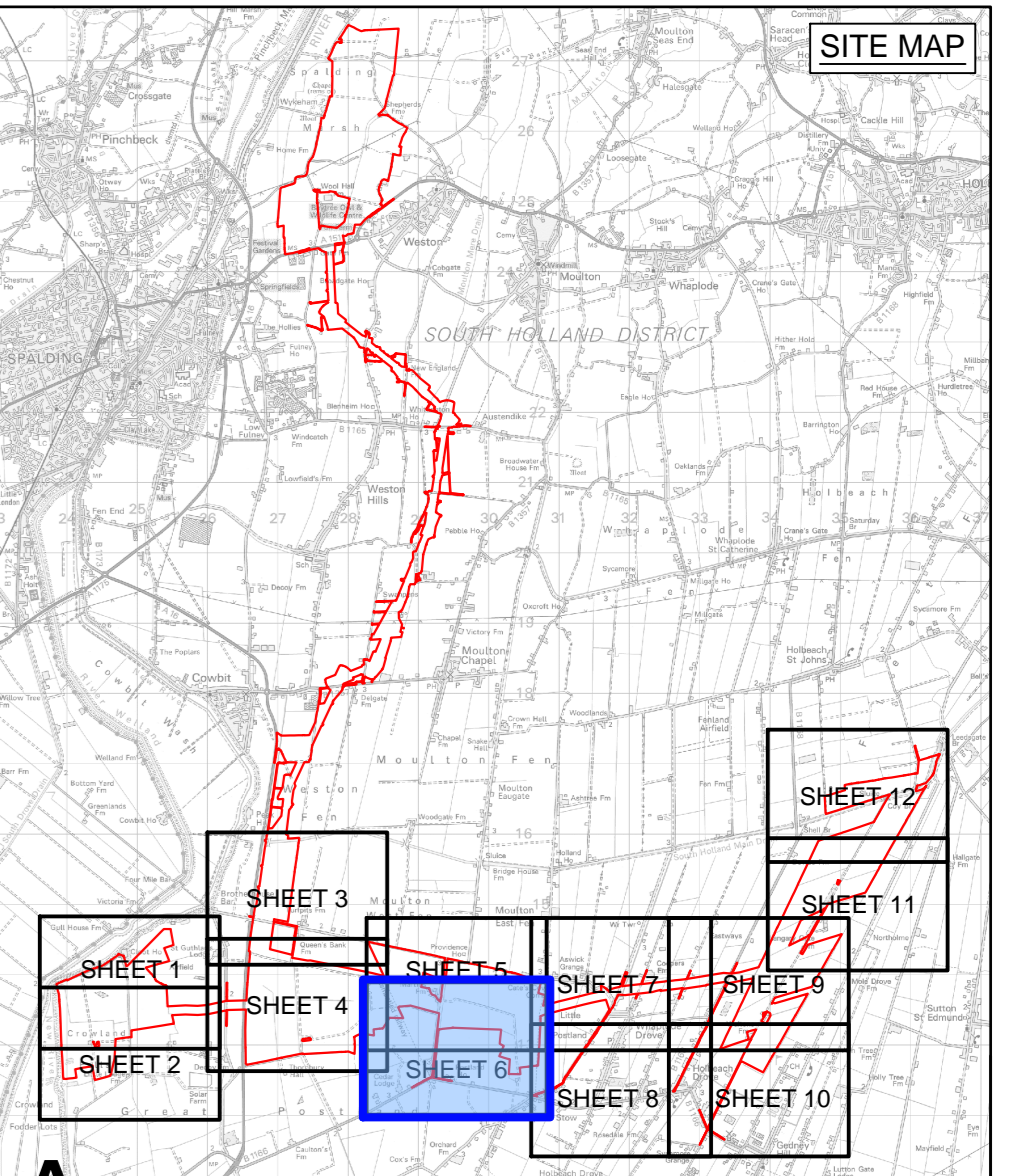

A

LEGEND

- Sheet index outlines
- Order Limits
- Tree Preservation Order
- Existing Preliminary Ecological Appraisal hedgerow
- Removed
- Retained
- Surveyed and National Tree Map trees within existing hedgerow
- Removed
- Retained

Notes

This drawing is scaled at paper size A0, therefore any prints taken at smaller sizes will affect accuracy of the measurement units and should not be scaled against.

The local authorities' boundaries and titles are correct at the time of submission.

No historically important hedgerows have been identified within the order limits.

For information on the types of works (i.e. removed / affected managed / potentially impacted) and the removal of trees, refer to the ES Appendix 12-8: Arboricultural Impact Assessment (Doc Ref. 6.3).

Copyright:
 National Tree Map – © Bluesky International Limited, National Hedgerow Map – © Bluesky International Limited, reproduced from Ordnance Survey digital map data © Crown Copyright 2025. All rights reserved. Licence number AC0000808122. Contains public sector information licensed under the Open Government Licence v3.0.

Tree categories as defined by BS 5837:2012.

Tree locations are based on aerial imagery and GPS co-ordinates from on site walkover.

*Indicates a tree / group whose position is approximate as based upon aerial photography and on site observations.

The original of this drawing was produced in colour – a monochrome copy should not be relied upon.

Hedgerow loss is shown indicatively; the final location of hedgerow removals may change, however the extent of removal will be consistent with that shown. Where the position of hedgerow loss is subject to change, it will avoid the removal of moderate or high quality tree features.

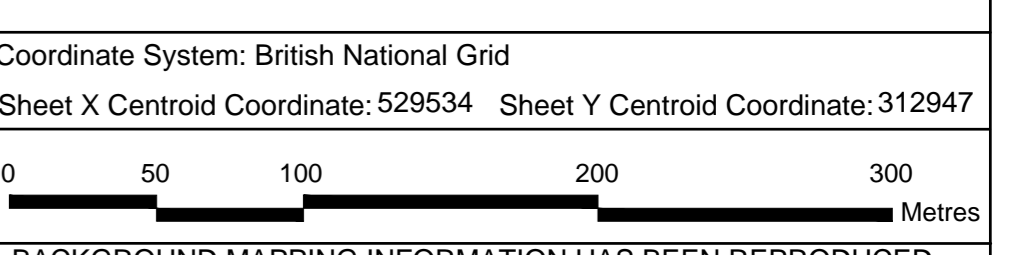

BACKGROUND MAPPING INFORMATION HAS BEEN REPRODUCED FROM THE ORDNANCE SURVEY BY PERMISSION OF ORDNANCE SURVEY OF THE CONTROLLER OF HIS MAJESTY'S STATIONERY OFFICE. © CROWN COPYRIGHT AND DATABASE RIGHTS (2025) ORDNANCE SURVEY AC0000808122

Issue	Date	Remarks	Drawn	Checked	Approved
0	MAR 2026	FOR DCO SUBMISSION	LH	TR	AW

Title

MERIDIAN SOLAR FARM
 HEDGEROW REGULATIONS AND TREE PRESERVATION ORDER PLAN
 REGULATION 5(2)(o)
 SECTION A SHEET 6 OF 12

Meridian Solar

Application Number: EN010169

Meridian Drawing Reference: DCO_AVR/PS/6

Scale	Sheet Size	Sheet	Issue
1:2500	A0	SHEET 6 OF 12	0

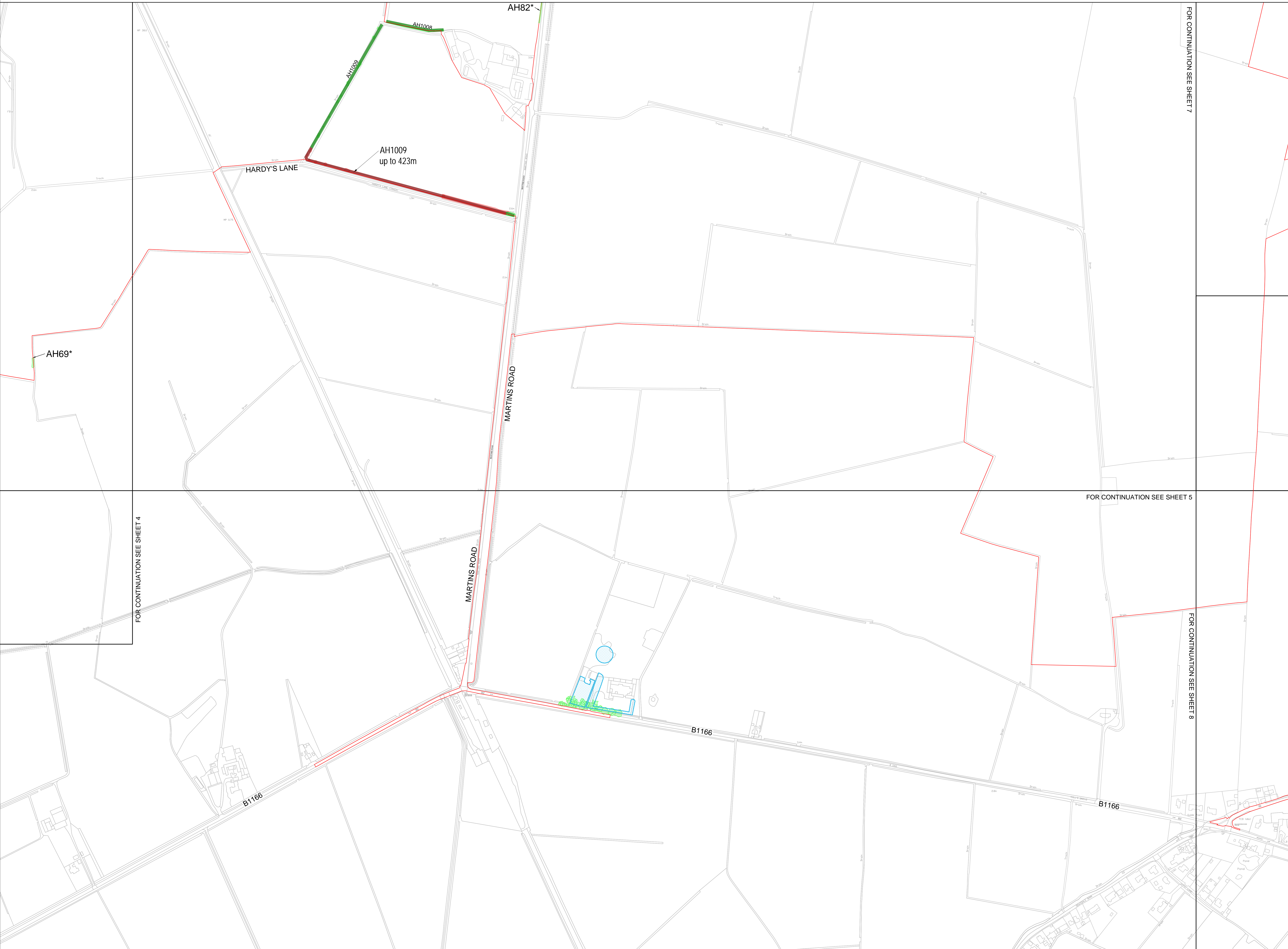



MERIDIAN SOLAR FARM
 HEDGEROW REGULATIONS AND TREE PRESERVATION ORDER PLAN
 REGULATION 5(2)(o)
 SECTION A SHEET 7 OF 12

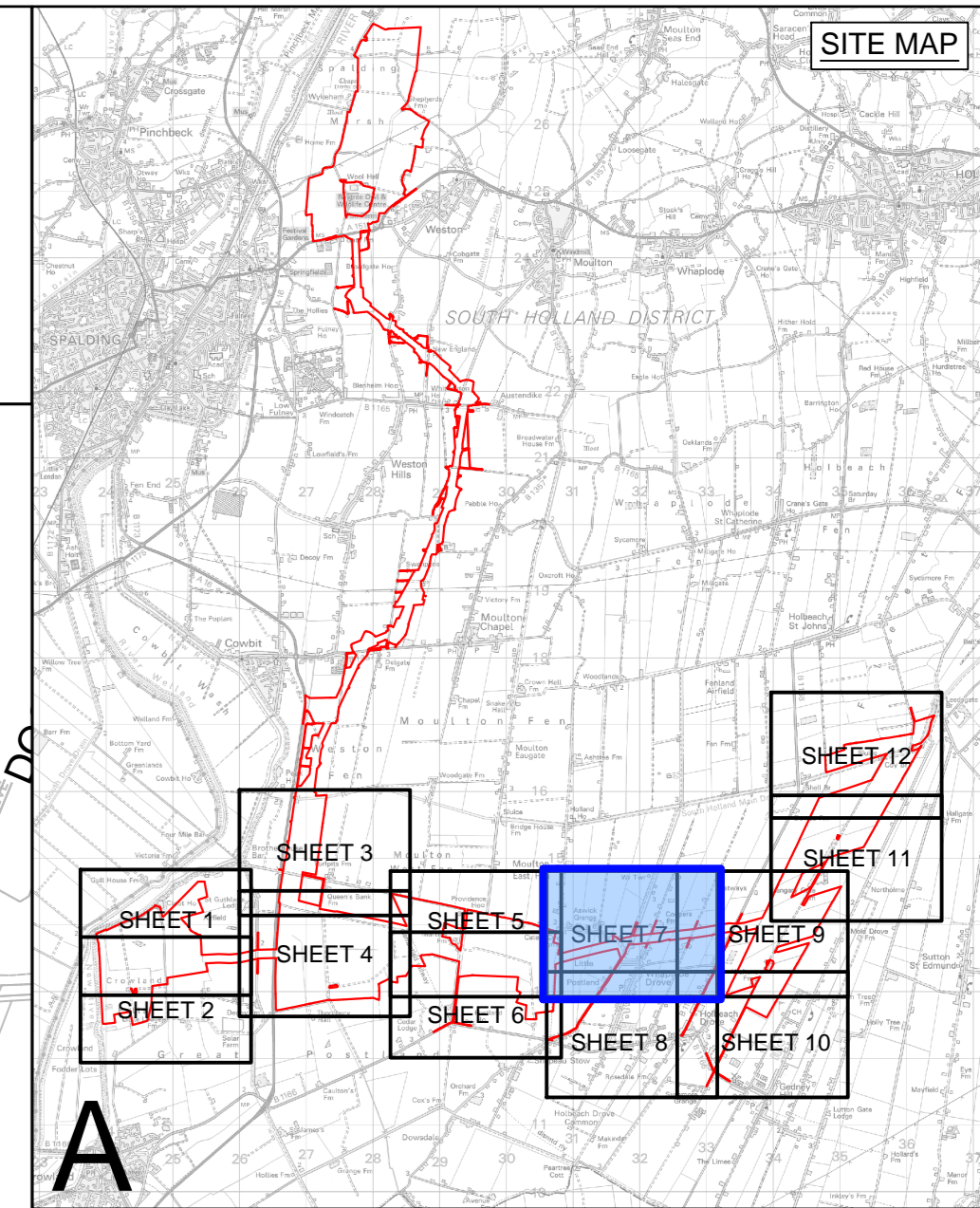

A

LEGEND

- Sheet index cutlines
- Order Limits
- Tree Preservation Order
- Existing Preliminary Ecological Appraisal hedgerow
- Removed
- Retained
- Surveyed and National Tree Map trees within existing hedgerow
- Removed
- Retained

Notes

This drawing is scaled at paper size A0, therefore any prints taken at smaller sizes will affect accuracy of the measurement units and should not be scaled against.

The local authorities' boundaries and titles are correct at the time of submission.

No historically important hedgerows have been identified within the order limits.

For information on the types of works (i.e. removed / affected managed / potentially impacted) and the removal of trees, refer to the ES Appendix 12-8: Articultural Impact Assessment (Doc Ref: 6.3).

Copyright:
 National Tree Map - © Bluesky International Limited, National Hedgerow Map - © Bluesky International Limited, reproduced from Ordnance Survey digital map data © Crown Copyright 2025. All rights reserved. Licence number AC00008122. Contains public sector information licensed under the Open Government Licence v3.0.

Tree categories as defined by BS 5837:2012.

Tree locations are based on aerial imagery and GPS co-ordinates from on site walkover.

*Indicates a tree / group whose position is approximate as based upon aerial photography and on site observations.

The original of this drawing was produced in colour - a monochrome copy should not be relied upon.

Hedgerow loss is shown indicatively; the final location of hedgerow removals may change, however the extent of removal will be consistent with that shown. Where the position of hedgerow loss is subject to change, it will avoid the removal of moderate or high quality tree features.

Coordinate System: British National Grid
 Sheet X Centroid Coordinate: 531876 Sheet Y Centroid Coordinate: 313861

BACKGROUND MAPPING INFORMATION HAS BEEN REPRODUCED FROM THE ORDNANCE SURVEY BY PERMISSION OF ORDNANCE SURVEY OF THE CONTROLLER OF HIS MAJESTY'S STATIONERY OFFICE. © CROWN COPYRIGHT AND DATABASE RIGHTS (2025) ORDNANCE SURVEY AC00008122

Issue	Date	Remarks	Drawn	Checked	Approved
0	MAR 2026	FOR DCO SUBMISSION	LH	TR	AW

Title

MERIDIAN SOLAR FARM
 HEDGEROW REGULATIONS AND TREE
 PRESERVATION ORDER PLAN
 REGULATION 5(2)(o)
 SECTION A SHEET 7 OF 12

Application Number	EN010169
Meridian Drawing Reference	DCO_AVR/PS/7
Scale	1:2500
Sheet Size	A0
Sheet	SHEET 7 OF 12
Issue	0

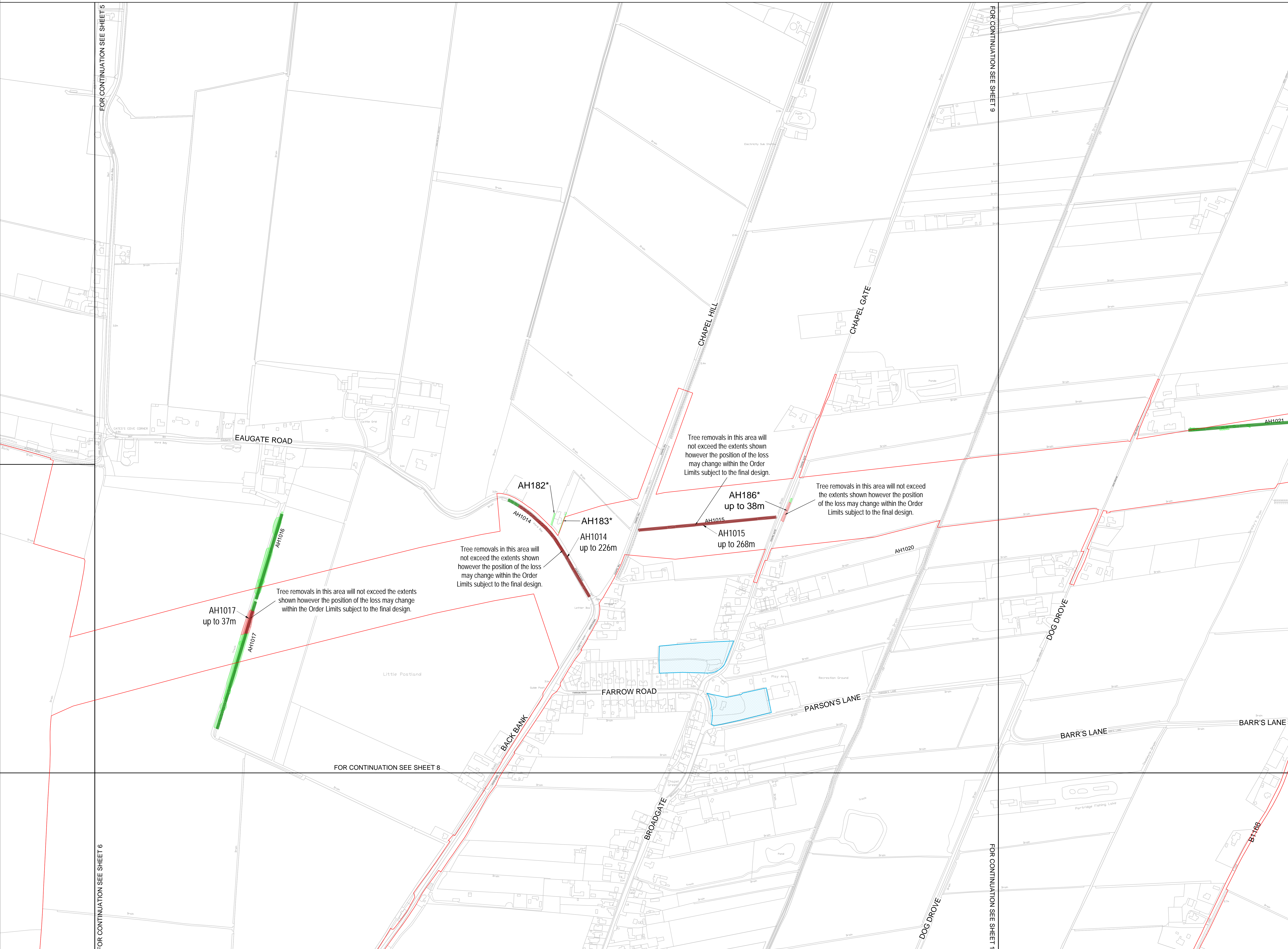



MERIDIAN SOLAR FARM
 HEDGEROW REGULATIONS AND TREE PRESERVATION ORDER PLAN
 REGULATION 5(2)(o)
 SECTION A SHEET 8 OF 12

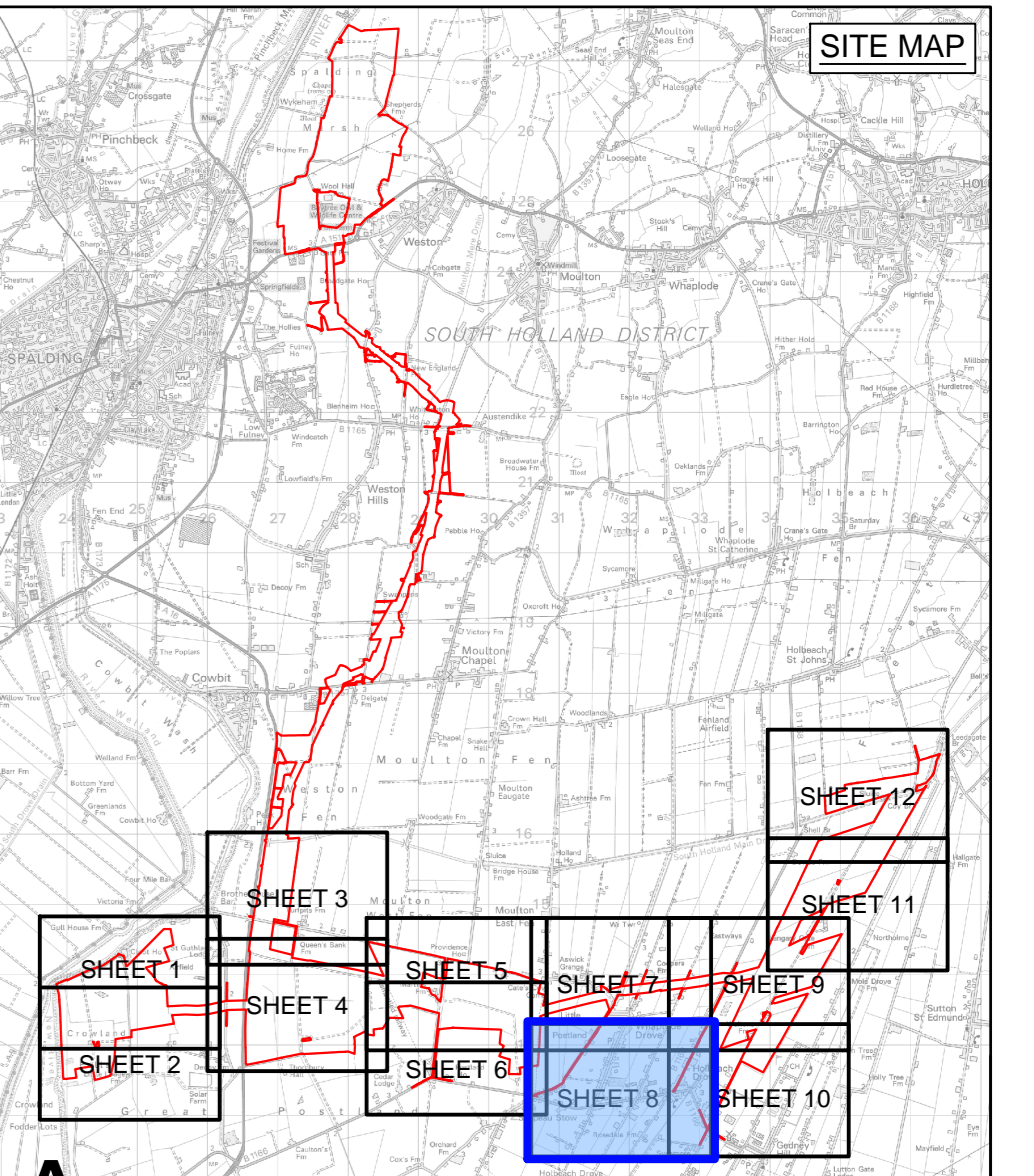

A

- LEGEND**
- Sheet index outlines
 - Order Limits
 - Tree Preservation Order
 - Existing Preliminary Ecological Appraisal hedgerow
 - Removed
 - Retained
 - Surveyed and National Tree Map trees within existing hedgerow
 - Removed
 - Retained

Notes

This drawing is scaled at paper size A0, therefore any prints taken at smaller sizes will affect accuracy of the measurement units and should not be scaled against.

The local authorities' boundaries and titles are correct at the time of submission.

No historically important hedgerows have been identified within the order limits.

For information on the types of works (i.e. removed / affected managed / potentially impacted) and the removal of trees, refer to the ES Appendix 12-8: Agricultural Impact Assessment (Doc Ref: 6.3).

Copyright:
 National Tree Map - © Bluesky International Limited, National Hedgerow Map - © Bluesky International Limited, reproduced from Ordnance Survey digital map data © Crown Copyright 2025. All rights reserved. Licence number AC0000808122. Contains public sector information licensed under the Open Government Licence v3.0.

Tree categories as defined by BS 5837:2012.

Tree locations are based on aerial imagery and GPS co-ordinates from on site walkover.

*Indicates a tree / group whose position is approximate as based upon aerial photography and on site observations.

The original of this drawing was produced in colour - a monochrome copy should not be relied upon.

Hedgerow loss is shown indicatively; the final location of hedgerow removals may change, however the extent of removal will be consistent with that shown. Where the position of hedgerow loss is subject to change, it will avoid the removal of moderate or high quality tree features.

Coordinate System: British National Grid
 Sheet X Centroid Coordinate: 531876 Sheet Y Centroid Coordinate: 312362

BACKGROUND MAPPING INFORMATION HAS BEEN REPRODUCED FROM THE ORDNANCE SURVEY BY PERMISSION OF ORDNANCE SURVEY OF THE CONTROLLER OF HIS MAJESTY'S STATIONERY OFFICE. © CROWN COPYRIGHT AND DATABASE RIGHTS (2025) ORDNANCE SURVEY AC0000808122

Issue	Date	Remarks	Drawn	Checked	Approved
0	MAR 2026	FOR DCO SUBMISSION	LH	TR	AW

Title

MERIDIAN SOLAR FARM
 HEDGEROW REGULATIONS AND TREE PRESERVATION ORDER PLAN
 REGULATION 5(2)(o)
 SECTION A SHEET 8 OF 12

Application Number		EN010169	
Meridian Drawing Reference		DCO_AVR/PS/8	
Scale	Sheet Size	Sheet	Issue
1:2500	A0	SHEET 8 OF 12	0



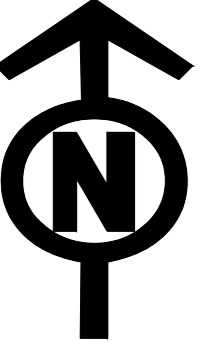

MERIDIAN SOLAR FARM
 HEDGEROW REGULATIONS AND TREE PRESERVATION ORDER PLAN
 REGULATION 5(2)(o)
 SECTION A SHEET 9 OF 12

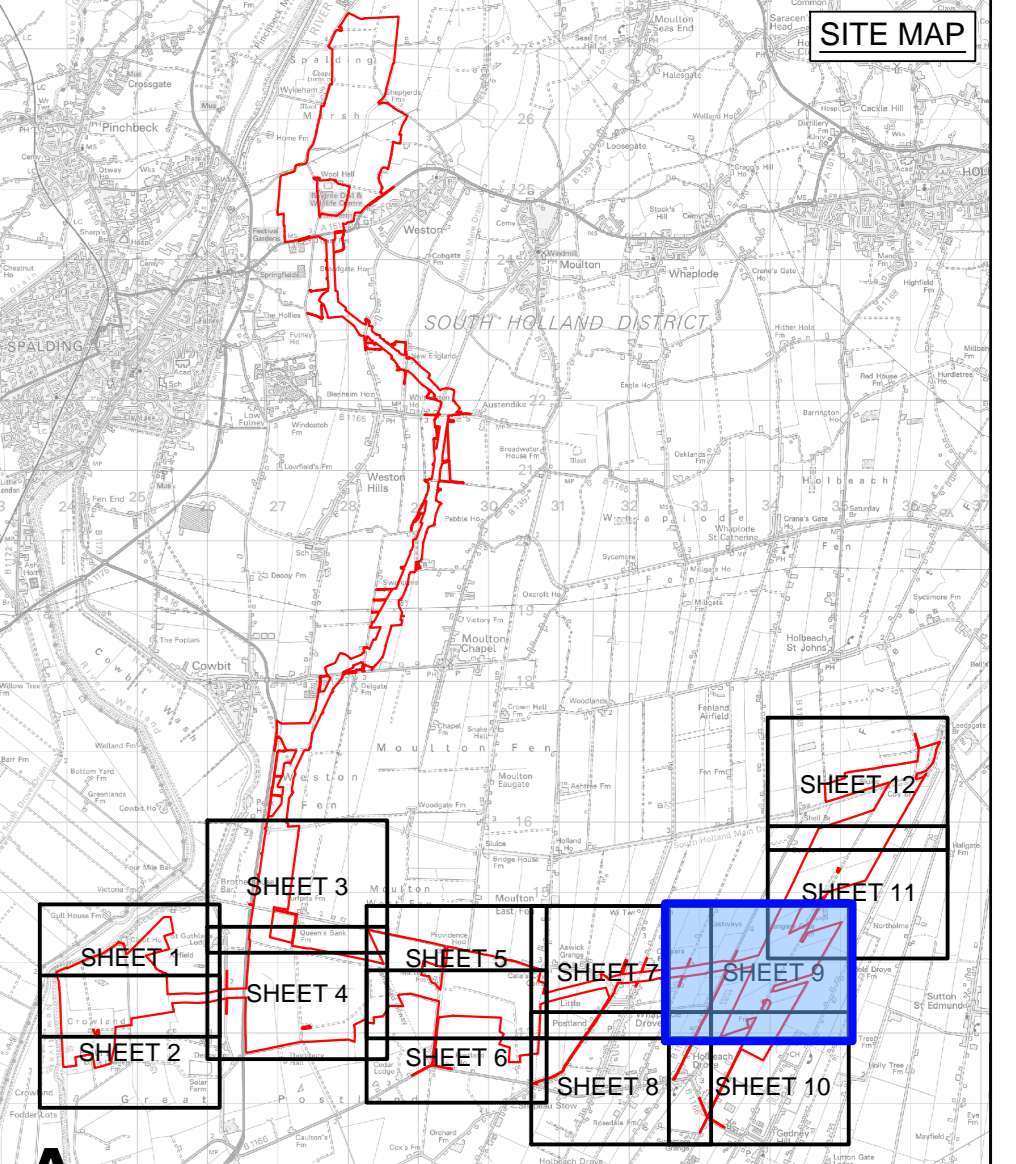

A

LEGEND

- Sheet index outlines
- Order Limits
- Existing ecologically important hedgerow to be retained
- Existing Preliminary Ecological Appraisal hedgerow
- Removed
- Retained
- Surveyed and National Tree Map trees within existing hedgerow
- Removed
- Retained

Notes

This drawing is scaled at paper size A0, therefore any prints taken at smaller sizes will affect accuracy of the measurement units and should not be scaled against.

The local authorities' boundaries and titles are correct at the time of submission.

No historically important hedgerows have been identified within the order limits.

For information on the types of works (i.e. removed / affected managed / potentially impacted) and the removal of trees, refer to the ES Appendix 12-8: Agricultural Impact Assessment (Doc Ref. 6.3).

Copyright:
 National Tree Map - © Bluesky International Limited, National Hedgerow Map - © Bluesky International Limited, reproduced from Ordnance Survey digital map data © Crown Copyright 2025. All rights reserved. Licence number AC00008122. Contains public sector information licensed under the Open Government Licence v3.0.

Tree categories as defined by BS 5837:2012.

Tree locations are based on aerial imagery and GPS co-ordinates from on site walkover.

*Indicates a tree / group whose position is approximate as based upon aerial photography and on site observations.

The original of this drawing was produced in colour - a monochrome copy should not be relied upon.

Hedgerow loss is shown indicatively; the final location of hedgerow removals may change, however the extent of removal will be consistent with that shown. Where the position of hedgerow loss is subject to change, it will avoid the removal of moderate or high quality tree features.

Coordinate System: British National Grid
 Sheet X Centroid Coordinate: 533836 Sheet Y Centroid Coordinate: 313861

BACKGROUND MAPPING INFORMATION HAS BEEN REPRODUCED FROM THE ORDNANCE SURVEY BY PERMISSION OF ORDNANCE SURVEY OF THE CONTROLLER OF HIS MAJESTY'S STATIONERY OFFICE. © CROWN COPYRIGHT AND DATABASE RIGHTS (2025) ORDNANCE SURVEY AC00008122

Issue	Date	Remarks	Drawn	Checked	Approved
0	MAR 2026	FOR DCO SUBMISSION	LH	TR	AW

Meridian Solar

Application Number: EN010169

Meridian Drawing Reference: DCO_AVR/PS/9

Scale: 1:2500 Sheet Size: A0 Sheet: SHEET 9 OF 12 Issue: 0

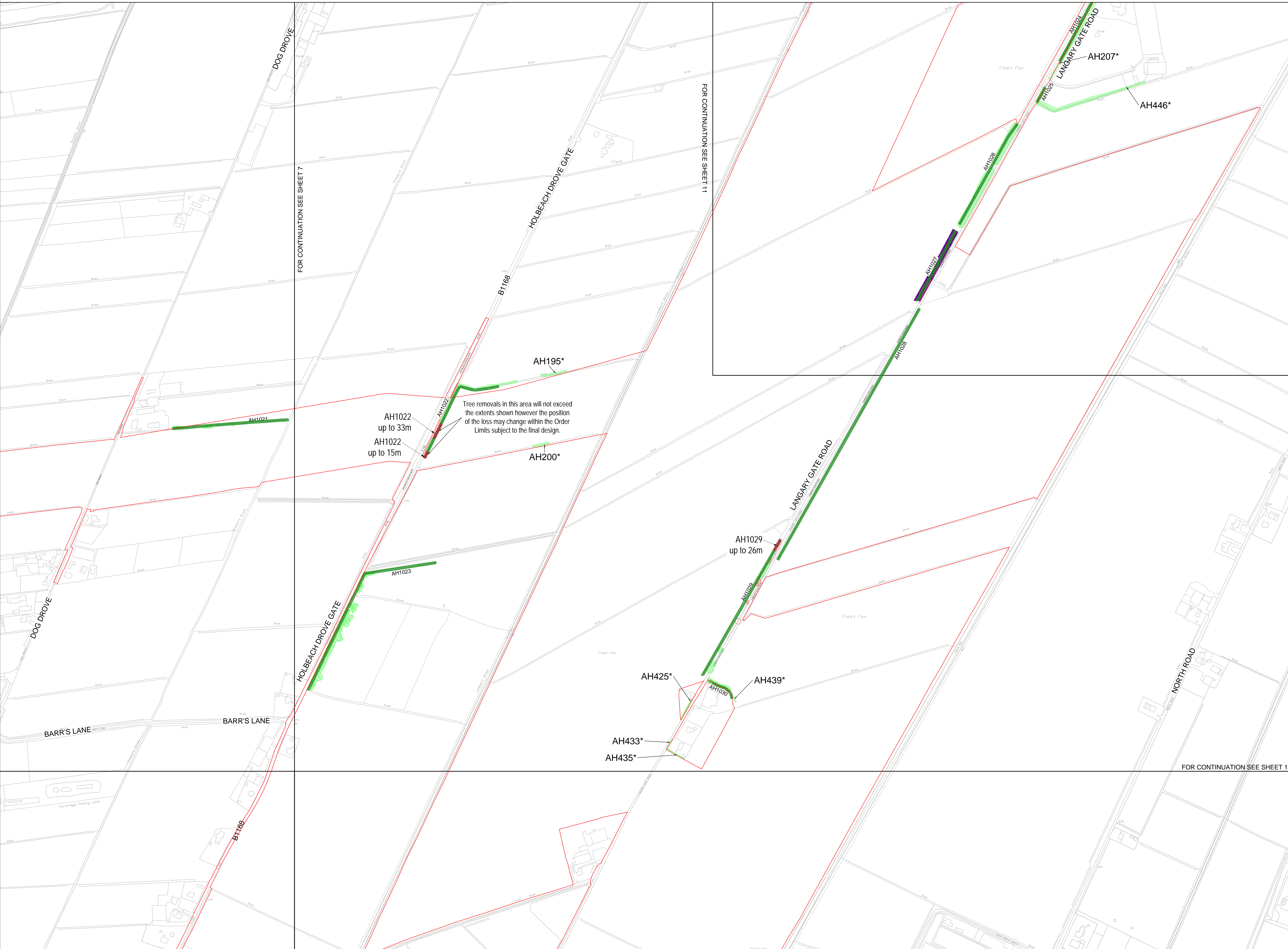



MERIDIAN SOLAR FARM
 HEDGEROW REGULATIONS AND TREE PRESERVATION ORDER PLAN
 REGULATION 5(2)(o)
 SECTION A SHEET 10 OF 12

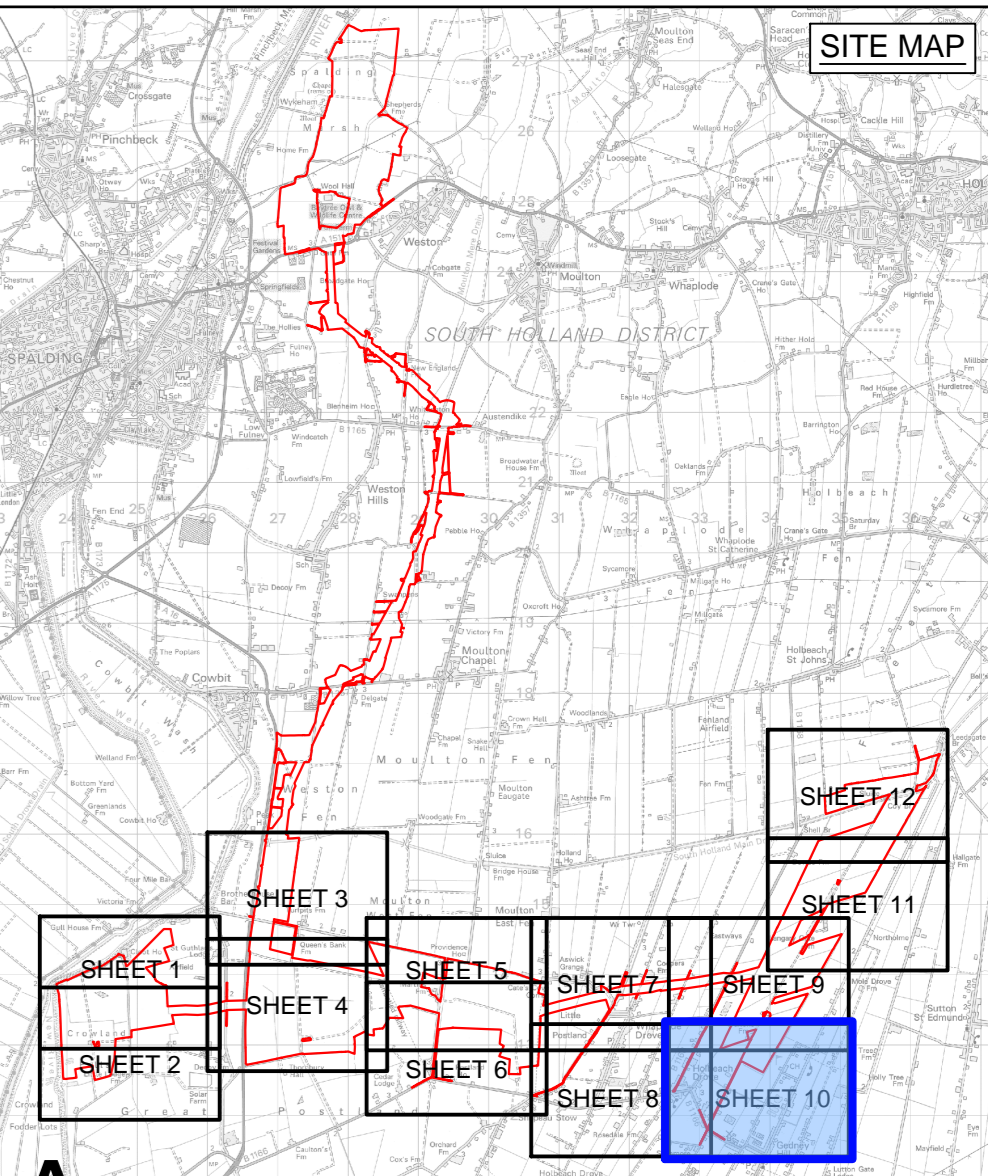

A

LEGEND

- Sheet index outlines
- Order Limits
- Tree Preservation Order
- Existing Preliminary Ecological Appraisal hedgerow
- Removed
- Retained
- Surveyed and National Tree Map trees within existing hedgerow
- Removed
- Retained

Notes

This drawing is scaled at paper size A0, therefore any prints taken at smaller sizes will affect accuracy of the measurement units and should not be scaled against.

The local authorities' boundaries and titles are correct at the time of submission.

No historically important hedgerows have been identified within the order limits.

For information on the types of works (i.e. removed / affected managed / potentially impacted) and the removal of trees, refer to the ES Appendix 12-8: Articultural Impact Assessment (Doc Ref: 6.3).

Copyright:
 National Tree Map – © Bluesky International Limited, National Hedgerow Map – © Bluesky International Limited, reproduced from Ordnance Survey digital map data © Crown Copyright 2025. All rights reserved. Licence number AC0000808122. Contains public sector information licensed under the Open Government Licence v3.0.

Tree categories as defined by BS 5837:2012.

Tree locations are based on aerial imagery and GPS co-ordinates from on site walkover.

*Indicates a tree / group whose position is approximate as based upon aerial photography and on site observations.

The original of this drawing was produced in colour – a monochrome copy should not be relied upon.

Hedgerow loss is shown indicatively; the final location of hedgerow removals may change, however the extent of removal will be consistent with that shown. Where the position of hedgerow loss is subject to change, it will avoid the removal of moderate or high quality tree features.

Coordinate System: British National Grid
 Sheet X Centroid Coordinate: 533836 Sheet Y Centroid Coordinate: 312362

BACKGROUND MAPPING INFORMATION HAS BEEN REPRODUCED FROM THE ORDNANCE SURVEY BY PERMISSION OF ORDNANCE SURVEY OF THE CONTROLLER OF HIS MAJESTY'S STATIONERY OFFICE. © CROWN COPYRIGHT AND DATABASE RIGHTS (2025) ORDNANCE SURVEY AC0000808122

Issue	Date	Remarks	Drawn	Checked	Approved
0	MAR 2026	FOR DCO SUBMISSION	LH	TR	AW

Title

MERIDIAN SOLAR FARM
 HEDGEROW REGULATIONS AND TREE
 PRESERVATION ORDER PLAN
 REGULATION 5(2)(o)
 SECTION A SHEET 10 OF 12

Application Number	EN010169
Meridian Drawing Reference	DCO A/NR/PS/10
Scale	1:2500
Sheet Size	A0
Sheet	SHEET 10 OF 12
Issue	0

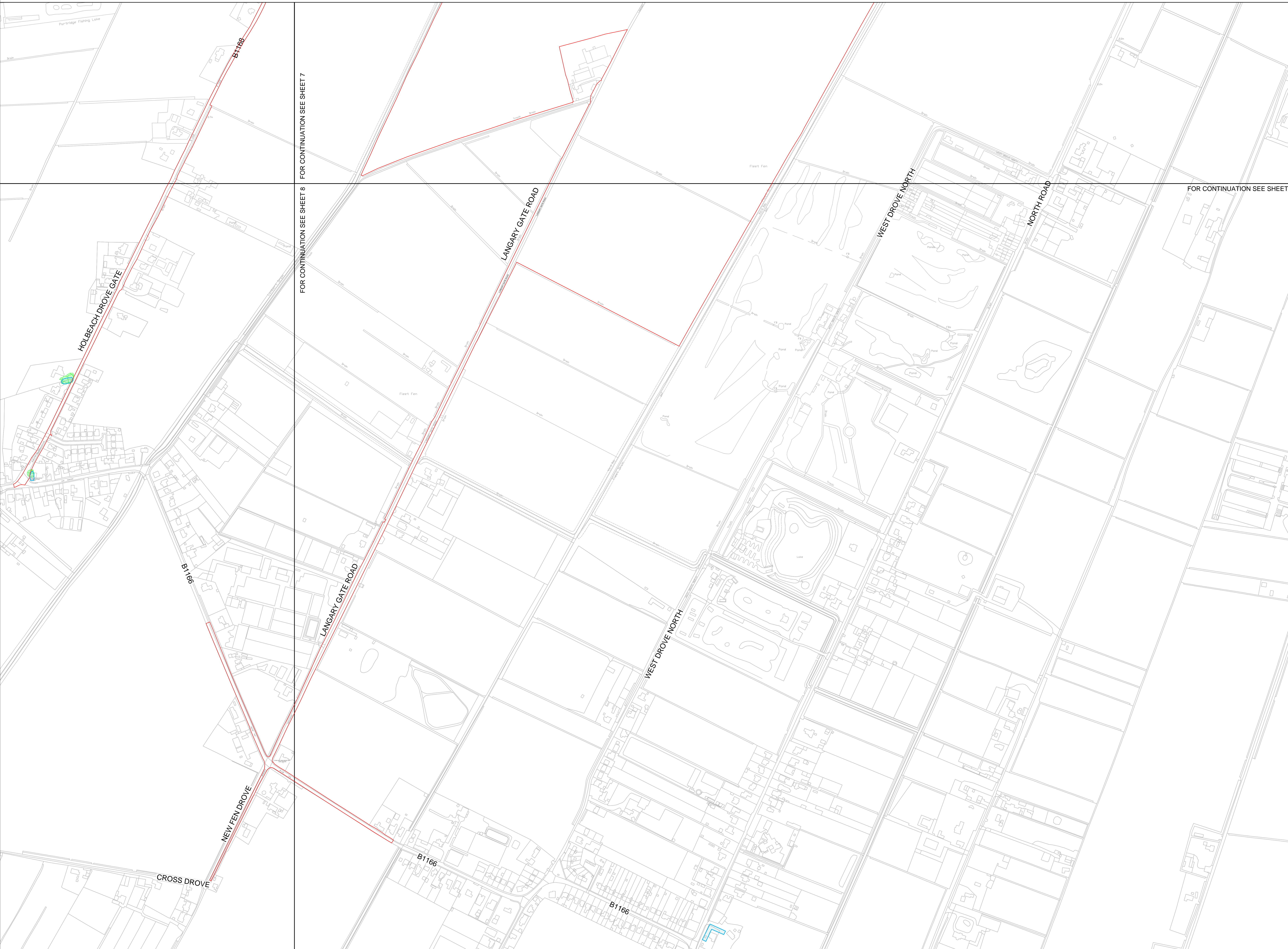

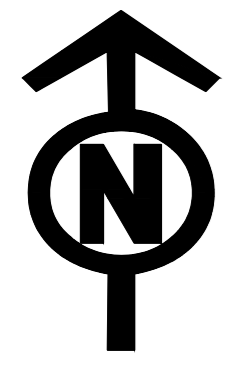

MERIDIAN SOLAR FARM
 HEDGEROW REGULATIONS AND TREE PRESERVATION ORDER PLAN
 REGULATION 5(2)(o)
 SECTION A SHEET 11 OF 12

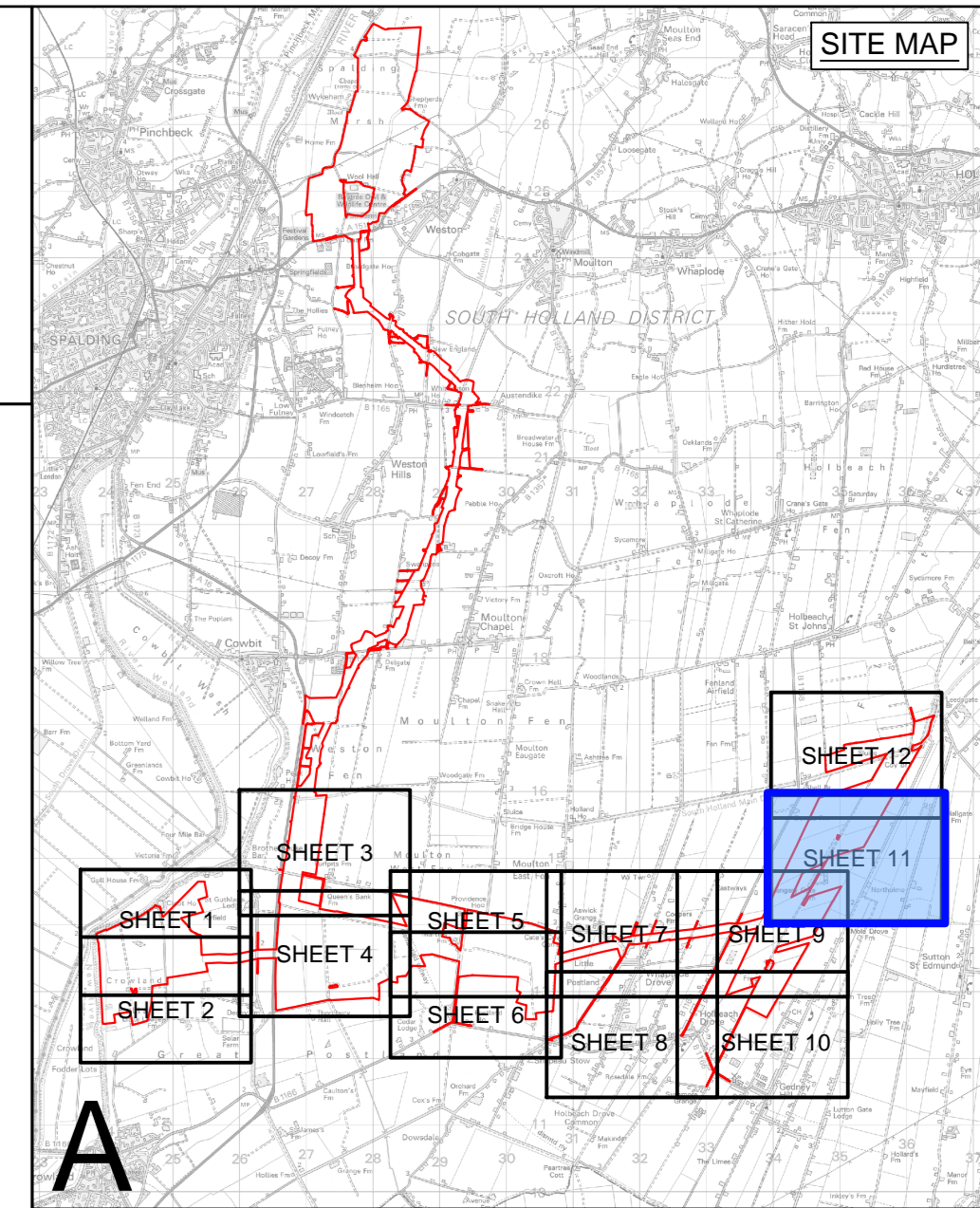

A

LEGEND

- Sheet index outlines
- Order Limits
- Existing ecologically important hedgerow to be retained
- Existing Preliminary Ecological Appraisal hedgerow
- Removed
- Retained
- Surveyed and National Tree Map trees within existing hedgerow
- Removed
- Retained

Notes

This drawing is scaled at paper size A0, therefore any prints taken at smaller sizes will affect accuracy of the measurement units and should not be scaled against.

The local authorities' boundaries and titles are correct at the time of submission.

No historically important hedgerows have been identified within the order limits.

For information on the types of works (i.e. removed / affected managed / potentially impacted) and the removal of trees, refer to the ES Appendix 12-8: Arboricultural Impact Assessment (Doc Ref. 6.3).

Copyright:
 National Tree Map – © Bluesky International Limited, National Hedgerow Map – © Bluesky International Limited, reproduced from Ordnance Survey digital map data © Crown Copyright 2025. All rights reserved. Licence number AC00008122. Contains public sector information licensed under the Open Government Licence v3.0.

Tree categories as defined by BS 5837:2012.

Tree locations are based on aerial imagery and GPS co-ordinates from on site walkover.

*Indicates a tree / group whose position is approximate as based upon aerial photography and on site observations.

The original of this drawing was produced in colour – a monochrome copy should not be relied upon.

Hedgerow loss is shown indicatively; the final location of hedgerow removals may change, however the extent of removal will be consistent with that shown. Where the position of hedgerow loss is subject to change, it will avoid the removal of moderate or high quality tree features.

Coordinate System: British National Grid
 Sheet X Centroid Coordinate: 536243 Sheet Y Centroid Coordinate: 315000

BACKGROUND MAPPING INFORMATION HAS BEEN REPRODUCED FROM THE ORDNANCE SURVEY BY PERMISSION OF ORDNANCE SURVEY OF THE CONTROLLER OF HIS MAJESTY'S STATIONERY OFFICE. © CROWN COPYRIGHT AND DATABASE RIGHTS (2025) ORDNANCE SURVEY AC00008122

Issue	Date	Remarks	Drawn	Checked	Approved
0	MAR 2026	FOR DCO SUBMISSION	LH	TR	AW

Meridian Solar

Application Number: EN010169

Meridian Drawing Reference: DCO_A/R/PS/11

Scale: 1:2500 Sheet Size: A0 Sheet: SHEET 11 OF 12 Issue: 0



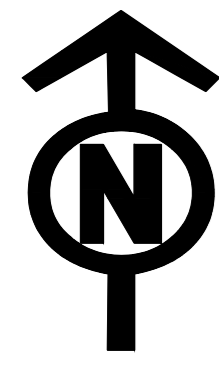

MERIDIAN SOLAR FARM
 HEDGEROW REGULATIONS AND TREE PRESERVATION ORDER PLAN
 REGULATION 5(2)(o)
 SECTION A SHEET 12 OF 12

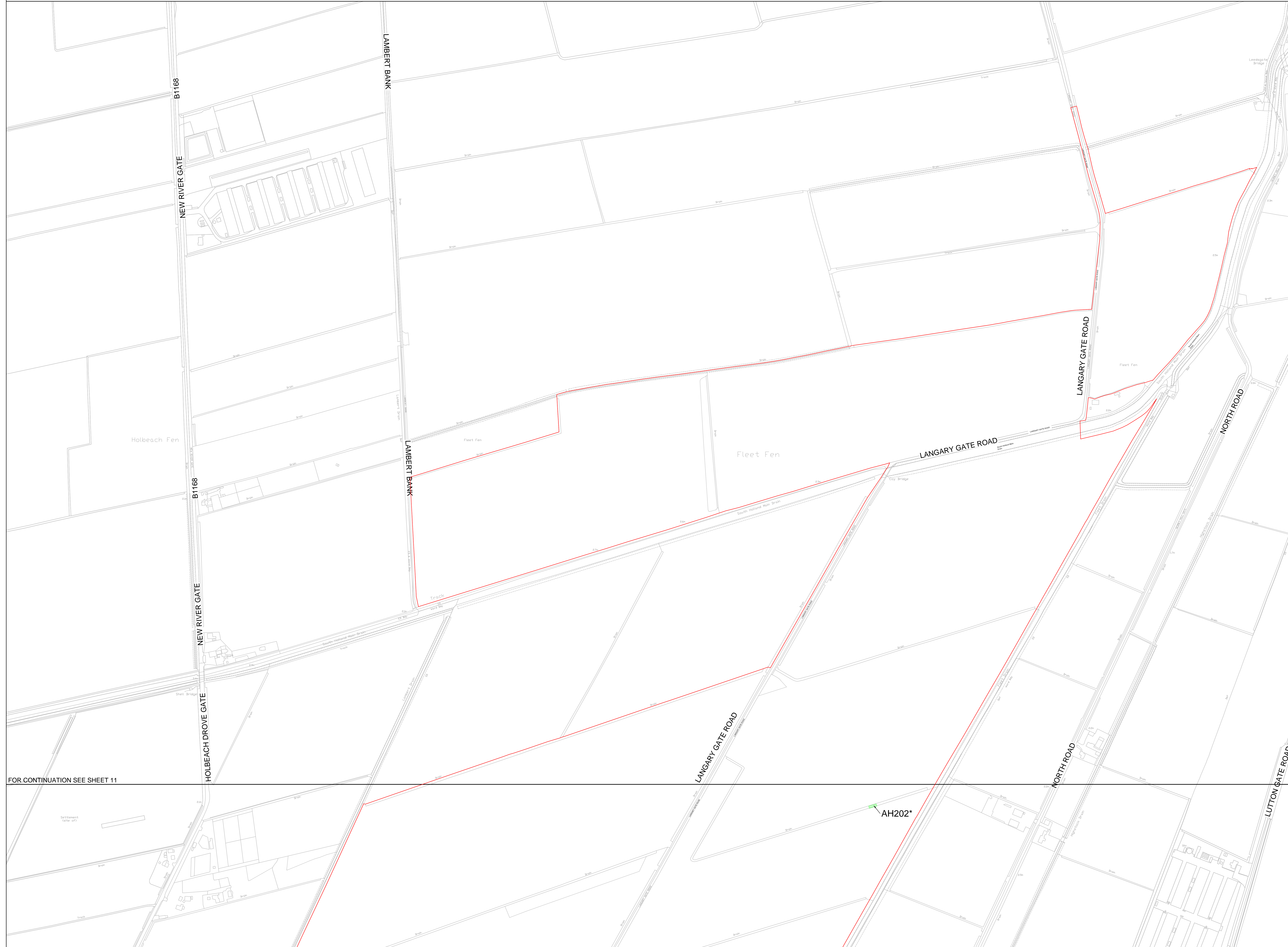
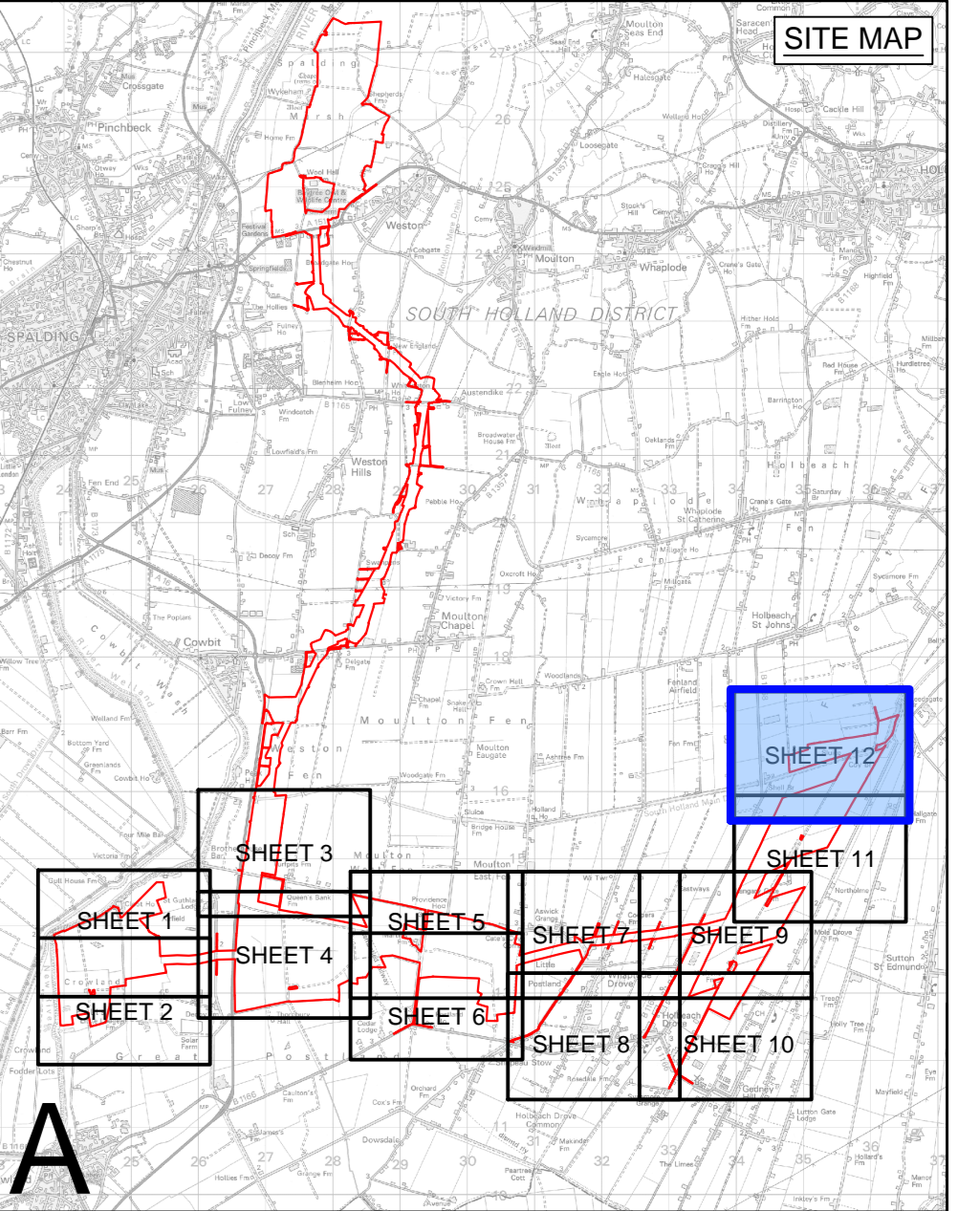

A

LEGEND

- Sheet index outlines
- Order Limits
- Existing Preliminary Ecological Appraisal hedgerow
- Removed
- Retained
- Surveyed and National Tree Map trees within existing hedgerow
- Removed
- Retained

Notes

This drawing is scaled at paper size A0, therefore any prints taken at smaller sizes will affect accuracy of the measurement units and should not be scaled against.

The local authorities' boundaries and titles are correct at the time of submission.

No historically important hedgerows have been identified within the order limits.

For information on the types of works (i.e. removed / affected managed / potentially impacted) and the removal of trees, refer to the ES Appendix 12-8: Artificial Impact Assessment (Doc Ref. 6.3).

Copyright:
 National Tree Map – © Bluesky International Limited, National Hedgerow Map – © Bluesky International Limited, reproduced from Ordnance Survey digital map data © Crown Copyright 2025. All rights reserved. Licence number AC00008122. Contains public sector information licensed under the Open Government Licence v3.0.

Tree categories as defined by BS 5837:2012.

Tree locations are based on aerial imagery and GPS co-ordinates from on site walkover.

*Indicates a tree / group whose position is approximate as based upon aerial photography and on site observations.

The original of this drawing was produced in colour – a monochrome copy should not be relied upon.

Hedgerow loss is shown indicatively; the final location of hedgerow removals may change, however the extent of removal will be consistent with that shown. Where the position of hedgerow loss is subject to change, it will avoid the removal of moderate or high quality tree features.

Coordinate System: British National Grid
 Sheet X Centroid Coordinate: 536243 Sheet Y Centroid Coordinate: 316539

BACKGROUND MAPPING INFORMATION HAS BEEN REPRODUCED FROM THE ORDNANCE SURVEY BY PERMISSION OF ORDNANCE SURVEY OF THE CONTROLLER OF HIS MAJESTY'S STATIONERY OFFICE. © CROWN COPYRIGHT AND DATABASE RIGHTS (2025) ORDNANCE SURVEY AC00008122

Issue	Date	Remarks	Drawn	Checked	Approved
0	MAR 2026	FOR DCO SUBMISSION	LH	TR	AW

Title

MERIDIAN SOLAR FARM
 HEDGEROW REGULATIONS AND TREE
 PRESERVATION ORDER PLAN
 REGULATION 5(2)(o)
 SECTION A SHEET 12 OF 12

Application Number: EN010169

Meridian Drawing Reference: DCO ANR/PS/12

Scale	Sheet Size	Sheet	Issue
1:2500	A0	SHEET 12 OF 12	0

FOR CONTINUATION SEE SHEET 11